

DEPARTMENT OF THE ARMY TECHNICAL MANUAL

TECHNICAL MANUAL

DIRECT SUPPORT, GENERAL SUPPORT

AND

DEPOT MAINTENANCE REPAIR PARTS

AND

SPECIAL TOOLS LISTS

WELDING MACHINE, ARC:

AC/DC, 300AMP TRANSFORMER RECTIFIER;

CONSTANT CURRENT, BASE MOUNTED

(EUTECTIC CORP. MODEL MD301 FED)

FSN 3431-235-4728

HEADQUARTERS, DEPARTMENT OF THE ARMY

28 OCTOBER 1971

TECHNICAL MANUAL

No. 5-3431-228-34P

HEADQUARTERS
DEPARTMENT OF THE ARMY
WASHINGTON, D.C., 28 October 1971

DIRECT SUPPORT, GENERAL SUPPORT AND DEPOT MAINTENANCE

REPAIR PARTS AND SPECIAL TOOL LIST

**WELDING MACHINE, ARC: AC/DC, 300AMP
TRANSFORMER RECTIFIER; CONSTANT CURRENT,
BASED MOUNTED
(EUTECTIC CORP. MODEL MD301FED)**

FSN 3431-235-4728

Current as of 18 October 1971

		Paragraph	Page
SECTION I. INTRODUCTION			
	Scope	1	iii
	General	2	iii
	Explanation of columns	3	iii
	Special information	4	v
	How to locate repair parts	5	v
	Federal supply codes for manufacturers	6	v
	Recommendations for maintenance publication improvements	7	vi
		<i>Listing</i>	<i>Illus.</i>
		<i>Page</i>	<i>Figure</i>
II. REPAIR PARTS FOR DIRECT SUPPORT, GENERAL SUPPORT AND DEPOT MAINTENANCE			
Group	01 Frame and cabinet	1	1
	02 Ventilating system	1	2
	03 Electronic components	3	3-7
	04 Electrical controls and associated parts	7	8-11
	05 Hydraulic components	11	12
	06 Remote control	12	13
	07 Accessories	14	14
SECTION	III. SPECIAL TOOLS, TEST AND SUPPORT EQUIPMENT FOR DIRECT SUPPORT, GENERAL SUPPORT AND DEPOT MAINTENANCE (Not applicable)		
	IV. INDEX—FEDERAL STOCK NUMBER AND REFERENCE NUMBER CROSS-REFERENCE TO FIGURE AND ITEM NUMBER		29

SECTION I.

INTRODUCTION

1. Scope.

This manual lists repair parts, special tools, test and support equipment required for the performance of direct support, general support, and depot maintenance of the welding machine.

2. General

This Repair Parts and Special Tools List is divided into the following sections:

a. Repair Parts-Section II. A list, in figure and item number sequence, of repair parts authorized for the performance of maintenance at the direct support, general support, and depot level, including those items which must be removed for replacement of the authorized item. Items, except kits and sets, are listed by assembly groups in top down breakdown sequence. Repair parts kits and sets are listed separately, if applicable, at the end of the Repair Parts List without regard to the assembly group to which they belong, (components of the kits and sets are listed in their proper sequence in the assembly group to which they belong and are referenced to the FSN of the kit or set.

b. Special Tools, Test and Support Equipment-Section III.

Not applicable.

c. Federal Stock Number and Reference Number Index-Section IV. A list of Federal stock numbers in ascending numerical sequence followed by a list of reference numbers in ascending alpha-numeric sequence, cross-referenced to the illustration figure number and item number.

3. Explanation of Columns

The following provides an explanation of columns in the tabular lists in Sections II and III.

a. Source, Maintenance, and Recoverability Code (SMR).

(1) Source code indicates the source for the listed items. Source codes are:

<i>Code</i>	<i>Explanation</i>
P	Repair Parts, Special Tools and Test Equipment supplied from GSA/ DSA, or Army supply system, and authorized for use at indicated maintenance categories.
P2	Repair Parts, Special Tools and Test Equipment which are procured and stocked for insurance purposes because the combat or military essentiality of the end item dictates that a minimum quantity be available in the supply system.

<i>Code</i>	<i>Explanation</i>
M	Repair Parts, Special Tools and Test Equipment which are not procured or stocked, as such, in the supply system but are to be manufactured at indicated maintenance levels.
A	Assemblies which are not procured or stocked as such, but are made up of two or more units. Such component units carry individual stock numbers and descriptions, are procured and stocked separately and can be assembled to form the required assembly at indicated maintenance categories.
X	Parts and assemblies that are not procured or stocked because the failure rate is normally below that of the applicable end item or component. The failure of such part or assembly should result in retirement of the end item from the supply system.
X1	Repair Parts which are not procured or stocked. The requirement for such items will be filled by the next higher assembly or component.
X2	Repair Parts, Special Tools and Test Equipment which are not stocked and have no foreseen mortality. The indicated maintenance category requiring such repair parts will attempt to obtain the parts through cannibalization or salvage, the item may be requisitioned with exception data, from the end item manager, for immediate use.
G	Major assemblies that are procured with PEMA funds for initial issue only as exchange assemblies at DSU [†] and GSU level. These assemblies will not be stocked above DS and GS level or returned to depot supply level.

(2) Maintenance code indicates the lowest category of maintenance authorized to install the listed item. The maintenance level codes are:

<i>Code</i>	<i>Explanation</i>
C	Operator/Crew maintenance
O	Organizational maintenance
F	Direct Support maintenance
H	General Support maintenance
D	Depot maintenance

(3) Recoverability code indicates whether unserviceable items should be returned for recovery or salvage. Items not coded are expendable. Recoverability codes are:

<i>Code</i>	<i>Explanation</i>
R	Applied to repair parts, (assemblies and components) special tools and test equipment which are considered economically repairable at direct and general support maintenance levels. When the item is no longer economically repairable, it is normally disposed of at the GS level. When supply considerations dictate, some of the repair parts may be listed for automatic return to supply for depot level repair as set forth in AR 710-50. When so listed, they will be replaced by supply on an exchange basis.
S	Repair Parts, Special Tools, Test Equipment and assemblies which are economically repairable at DSU and GSU activities and which normally are furnished by supply on an exchange basis. When items are determined by a GSU to be uneconomically repairable, they will be evacuated to a depot for evaluation and analysis before final disposition.
T	Higher dollar value recoverable repair parts, special tools and test equipment which are subject to special handling and are issued on an exchange basis. Such items will be repaired or overhauled at depot maintenance activities only. No repair may be accomplished at lower levels.
U	Repair Parts, Tools and Test Equipment specifically selected for salvage by reclamation units because of precious metal content, critical materials, high dollar value or reusable casings or castings.

b. Federal Stock Number. This column indicates the Federal stock number assigned to the item and will be used for requisitioning purposes.

c. Description. This column indicates the Federal item name and a minimum characteristic description required to describe the item. Assembly components and subassemblies are indented under major assemblies. The abbreviation "w/e" when used as a part of the nomenclature indicates the Federal stock number includes all armament, equipment, accessories, and repair parts issued with the item. A part number or other reference number is followed by the applicable five-digit Federal supply code for manufacturer in parenthesis. Repair part quantities included in kits and sets are shown in front of the repair part name. Material required for manufacture or fabrication is identified.

d. Unit of Measure (U/M). A two-character alphabetic abbreviation indicating the amount or quantity of the item, as used, upon which the allowances are based, e.g., ft, ea, pr, etc.

e. Quantity Incorporated in Unit. This column indicates the quantity of the item used in

the assembly group. A "V" appearing in this column in lieu of a quantity indicates that a definite quantity cannot be indicated (e. g., shims, spacers, etc.).

f. Thirty-Day DS/GS Maintenance Allowances.

Note. Allowances in the GS column are for GS maintenance only.

(1) The allowance columns are divided into three subcolumns. Indicated in each subcolumn, opposite the first appearance of each item, is the total quantity of items authorized for the number of equipments supported. Subsequent appearances of the same item will have the letters "REF" in the applicable allowance columns indicating total allowance quantities will be shown with the first appearance of the item. To locate the referenced item, locate the FSN or reference number in the index. The earliest figure and item number is the referenced item. Items authorized for use as required but not for initial stockage are identified with an asterisk in the allowance column.

(2) The quantitative allowances for DS GS levels of maintenance will represent initial stockage for a 30-day period for the number of equipments supported.

(3) To determine allowances when supporting more than 100 of these equipments: First, divide the number of equipments supported by 100 by moving the decimal two places left; second, multiply the result by the quantity in the 51-100 density column. Example, authorized allowances for 51-100 equipments is 40; for 150 equipments multiply 40 by 1.50 or 60 parts required.

g. One-Year Allowances Per 100 Equipments Contingency Planning Purposes. This column indicates opposite the first appearance of each item the total quantity required for distribution and contingency planning purposes. Subsequent appearances of the same item will have the letters "REF" in this column. To locate the referenced item, locate the FSN or reference number in the index. The earliest figure and item number is the referenced item. The range of items indicates total quantities of all authorized items required to provide adequate support of 100 equipments for one year.

h. Depot Maintenance Allowance Per 100 Equipments. This column indicates opposite the first appearance of each item the total quantity authorized for depot maintenance of 100 equipments. Subsequent appearances of the same item

will have the letters "REF" in the allowance column. To locate the referenced item, locate the FSN or reference number in the index. The earliest figure and item number is the referenced item. Items authorized for use as required but not for initial stockage are identified with an asterisk in the allowance column.

i. Illustration. This column is divided as follows:

(1) *Figure number.* Indicates the figure number of the illustration on which the item is shown.

(2) *Item number.* Indicates the Callout number used to reference the item in the illustration.

4. Special Information

a. Repair parts mortality has been based on 1500 hours of operation per year.

b. Parts which require manufacture or assembly at a category higher than that authorized for installation will indicate in the source column the higher category.

c. The following publications pertain to the welding machine and its components:

TM 5-3431-228-14 Operator, Organizational, DS, and (GS Maintained Manual.

TM 5-3431-228-20P Organizational Maintenance Repair Parts and Special Tools List.

5. How to Locate Repair Parts

a. When Federal stock number or reference number is unknown:

(1) *First.* Using the table of contents, determine the assembly group within which the repair part belongs. This is necessary since illustrations are prepared for assembly groups, and listings are divided into the same groups.

(2) *Second.* Find the illustration covering the assembly group to which the repair part belongs.

(3) *Third.* Identify the repair part on the illustration and note the illustration figure number and item number of the repair part.

(4) *Fourth.* Using the Repair Parts Listing, find the assembly group to which the repair part belongs and locate the illustration figure and item noted on the illustration.

b. When the Federal stock number or reference is known.

(1) *First.* Using the Index of Federal Stock Numbers and Reference Numbers find the pertinent Federal stock number or reference

number. This index is in ascending FSN sequence followed by a list of reference numbers in ascending alpha-numeric sequence cross-referenced to the illustration figure number and item number.

(2) *Second.* Using the Repair Parts Listing, find the assembly group of the repair part and the illustration figure number and item number referenced in the Index of Federal Stock Numbers and Reference Numbers.

6. Federal Supply Codes for Manufacturers

<i>Code</i>	<i>Manufacturer</i>
60779.....	AMP, Inc., Harrisburg, Pa.
02660.....	Amphenol Corp., Broadview, Ill.
04009.....	Arrow-Hart and Hegeman Electric Co., Hartford, Conn.
04713.....	Motorola, Inc., Semiconductor Products Div., Phoenix, Ariz.
64845.....	Automatic Switch Co., Madison, N. J.
06383.....	Panduit Corp., Tinley Park, Ill.
08805.....	General Electric Co., Large Lamp Dept., Nela Park, Cleveland, Ohio
09023.....	Cornell-Dubilier Electric Corp., Electrolytics and Paper Tubular Div., Sanford, N. C.
09922.....	Burdy Corp., Norwalk, Conn.
16166.....	Western Enterprises, Inc., Bay Village, Ohio
22039.....	Omega Electric Co., Chicago, Ill.
26132.....	Hollingsworth Solderless Terminal, Ft. Lauderdale, Fla.
30323.....	Illinois Tool Works, Inc., Chicago, Ill.
30733.....	Lenco, Inc., Jackson, Mo.
34353.....	Tempel Steel, Chicago, Ill.
34463.....	Espe Mfg. Co., Schiller Park, Ill.
44655.....	Ohmite Mfg. Co., Skokie, Ill.
56289.....	Sprague Electric Co., Adams, Mass.
58849.....	Syntron Co., Homer City, Pa.
60399.....	Torrington Mfg. Co., Torrington, Conn.
62119.....	Universal Electric Co., Owosso, Mich.
71400.....	Bussman Mfg., Div. of McGraw-Edison, St. Louis, Mo.
71747.....	Chicago Hardware and Fixture Co., Franklin Park, Ill.
71785.....	Cinch Mfg. Co. and Howard B. Jones Div., Chicago, Ill.
72765.....	Drake Mfg. Co., Chicago, Illinois
73803.....	Texas Instruments, Inc., General Plate Div. Attleboro, Mass.
74193.....	Heineman Electric Co., Trenton, N. J.
74842.....	Illinois Lock Co., Wheeling, Ill.
74970.....	Johnson, E. F., Co., Waseca, Minn.
75138.....	Jefferson Electric Co., Bellwood, Ill.
75543.....	Lavelle Rubber Co., Chicago, Ill.
75915.....	Littlefuse, Inc., Des Plaines, Ill.
77342.....	American Machine and Foundry Co., Potter and Brumfield Div., Princeton, Ind.
77881.....	Rodale Mfg. Co., Emmaus, Pa.

<i>Code</i>	<i>Manufacturer</i>
78553	Tinnerman Products, Inc., Cleveland, Ohio
79470	Weatherhead Co., The, Cleveland, Ohio
81133	Electrical Utilities Co., LaSalle, Ill.
81483 .	International Rectifier Corp., El Segundo, Calif.
82807	Milwaukee Resistor Co., Milwaukee, Wis.
83330	Smith, Herman H., Inc., Brooklyn, N. Y.
88044	Aeronautical Standards Group Dept. of Navy and Air Force
90800 .	Hays Mfg. Co., Frie, Pa.
91929 .	Honeywell, Inc., Micro Switch Div., Freeport, Ill.
96073 .	Mid-States Welder Mfg. Co., Chicago, Ill.
96906 .	Military Standards Div., Directorate of Logistic Services, DSA

7. Recommendations for Maintenance Publication Improvements

Report of errors, omissions, and recommendations for improving this publication by the individual user is encouraged. Reports should be submitted on DA Form 2028 (Recommended Changes to Publications), and forwarded direct to Commanding General, U. S. Army Mobility Equipment Command, ATTN: AMSME-MPP, 4300 Goodfellow Boulevard, St. Louis, Mo. 63120.

SECTION II REPAIR PARTS FOR DIRECT SUPPORT, GENERAL SUPPORT, AND DEPOT MAINTENANCE (CONTINUED)

(1) SNR CODE	(2) FEDERAL STOCK NUMBER	(3) DESCRIPTION REFERENCE NUMBER & MFR. CODE	UNITS OF MEAS	(4) QTY REQD	(6)							UNIT PRICE	TOTAL PRICE	L I (a) FI NO	O) RATIO (b) ITEI NO
					30-DAY DS MA ALLOWANCE	(b) 1-5	(c) 1-1	(d) 1-1	(e) 1-1	(f) 1-1	(g) 1-1				
		GROUP 01- FRAME AND CABINET													
X2-0-		NUT, EYE C185A (71747)												1	
X2-0-		COVER, CAB INET 3G1817 (96073)												1	
P-0-	305-757-82	SCREW, TAPPING 4S1851-43 (96906)												3	
X2-0-		PACER 3G1817 (96073)												4	
P-0-	310-834-87	NUT, HEXAGON MS35691-33 (96906)												5	
X2-0-		PANEL, RIGHT SIDE G2175A (96073)												6	
P-0-	305-757-82	SCREW, TAPPING, THREAD FORMING MS1851-44 (96906)											1	7	
2-0-		SCREWING, FRONT G2250 (96073)											1	8	
P-0-	310-757-69	UT, SHEET SPRING 8109-8-4 (78553)		2									1	9	
P-0-	305-716-631	SCREW, TAPPING, THREAD FORMING 34-2516-80-0024 (30323)		1									1	10	
2-H-		BASE ASSEMBLY 3G2322 (96073)		1									1	11	
2-0-		PANEL, LEFT SIDE G2175 B (96073)		1									1	12	
2-0-		SCREWING, REAR G2286 (96073)		1									1	13	
1-0-		LABEL, VOLTAGE 14R2332 (96073)		1									1	14	
		GROUP 02 - VENTILATING SYSTEM													
-0-		FAN MOTOR AND BLADE ASSEMBLY 11 G2250 (96073)		1									2	1	
20-	4140-738-9881	IMPELLER, FAN, CENTRIFUGAL N1420-3 (60399)		1	*	*	*	*	*				2	2	
-0-		HOUSING ASSEMBLY, FAN 13G2408 (96073)		1									2	3	
-0-	5305-934-9751	NUT MS35650-302 (96906)		4	*	*	*	*	*				2	4	
P-0-	5310-851-2674	NUT, PLAIN, HEXAGON MS35691-1 (96906)		8	*	*	*	*	*				2	5	
P-0-	5310-582-3965	WASHER, LOCK MS35338-44 (96906)		8	*	*	*	*	*				2	6	
P-0-	5310-045-3296	WASHER, LOCK MS35338-43 (96906)		4	*	*	*	*	*				2	7	
X2-0-		STRAP, MOUNTING 13G2405 (96073)		1									2	8	
P-0-	5905-472-3577	RESISTOR, FIXED 19R1785 (96073)		2		1	2	1	1	2	2	5	2	9	
P-0-	5305-622-9485	SCREW, MACHINE MS35265-81 (96906)		4	*	*	*	*	*				2	10	

SECTION II REPAIR PARTS FOR DIRECT SUPPORT, GENERAL SUPPORT AND DEPOT MAINTENANCE (CONTINUED)

(1) SMR CODE	(2) FEDERAL STOCK NUMBER	DESCRIPTION REFERENCE NUMBER & MFR. CODE	(4) UNIT OF MEAS	(5) QTY INC IN UNIT	(6)						(8) J Y W P QU TGC	(9) EPO AIN W P 100 QU	O) RATIONS (b) ITEM NO.
					30-DAY DS ALLOWAN			30-D GS OWAN					
					(a) 1-20	(b) 1-50	(c) 1-100	(a) 1-20	(b) 1-50	(c) 1-100			
P-0-	305-021-3616	SCREW, CAP, HEXAGON HEAD MS35307-305 (96906)	EA	4	*	*	*	*	*	*			11
2-0-		BUS BAR 29 G1986-8 (96073)	EA	1									12
P-0-		MOTOR, FAN CB2J016-230V (62119)	EA	1	*	*	1	*	*	1			13
P20-	940-156-7135	TERMINAL, LUG 31256 (00779)	EA	2	*	*	*	*	*	*			14
P20-	150-451-3010	BUS BAR LEADS 29 G1960-2 (96073)	EA	1	*	*	*	*	*	*			15
GROUP 03 -ELECTRONIC COMPONENTS													
P-H-	950-472-3587	TRANSFORMER ASSEMBLY 27 G2241-2 (96073)	EA	1	*	1	1	*	1	1			1
1---		COIL, SECONDARY 26 G2327 (96073)		1									2
1---		INSULATOR 8G2303 (96073)		3									3
1---		CORE ASSEMBLY AND INSULATION 31 G1943 (96073)		1									4
1---		LAMINATION I SECTION 31 G1946-1 (96073)		2									5
1---		LAMINATION I SECTION 31 G1944-1 (96073)		1									6
1---		LAMINATION U SECTION 31 G1946 (96073)		2									7
1---		LAMINATION U SECTION 31 G1944 (96073)		1									8
1---		COIL, CONTROL 26 G2328 (96073)		4									9
2-H-	940-113-9825	TERMINAL, LUG R3461 (26132)	EA	2									10
1---		WEDGE 8G2197 (96073)		3									11
1---		STRIP, INSULATING 8G2264E (96073)		2									12
1---		STRIP, INSULATING 8G2264S (96073)		2									13
1---		COIL, SECONDARY 26G2326 (96073)		1									14
1---		WEDGE 8G2288 (96073)		4									15
1---		COIL, PRIMARY 26 G2324-1 (96073)		1									16
2-H-	940-115-0774	TERMINAL, LUG MS20659-113 (96906)	EA										17
2-H-	940-115-4991	TERMINAL, LUG MS-20659-131 (96906)	EA	4									18
2-H-	940-874-1006	TERMINAL, LUG R4124B (26132)	EA	2									19

SECTION II REPAIR PARTS FOR DIRECT SUPPORT, GENERAL SUPPORT, AND DEPOT MAINTENANCE (CONTINUED)

(1) SMR CODE	(2) FEDERAL STOCK NUMBER	(3) DESCRIPTION REFERENCE NUMBER & MFR. CODE USABLE ON CODE	(4) UNIT OF MEAS	(5) QTY C IN KIT	(6) 30-DAY DS ALLOWA		INT	(7)		(8) I W I Q L TTC	(9) P I N O U	US a) 16 10.	ITIONS (b) ITEM NO.
					(b) -50	(c) -10		30-D a) -20	GS WA b) -5				
X1---		COIL, PRIMARY 26 G2325-1 (96073)		1								3	20
X1---		INSULATOR, GAP 8G2137F (96073)		2								3	21
-P2H-	950-472-3580	ILTER, REACTOR ASSEMBLY 7G1581-B (96073)	EA	1	*			*				4	1
X1---		LEG, REACTOR BRACKET 13 G1834 (96073)		4								4	2
-P-H-	305-716-6288	SCREW, CAP, HEXAGON HEAD 1300-7R2016 (96073)	EA	4	*	*	*	*				4	3
X1---		SPACER 8G2255 (96073)		1								4	4
X1---		WEDGE 8G2198 (96073)		2								4	5
X1---		FILTER COIL ASSEMBLY 26 G2286 (96073)		1								4	6
X1---		INSULATOR 8G2233-5 (96073)		2								4	7
X1---		CORE E1225SH (34353)		1								4	8
-P-H-	310-582-8965	WASHER, LOCK MS35338-44 (96906)	EA	4	REY	RE	REF	RE		R	R	4	9
-P-H-	310-809-3078	WASHER, FLAT MS27183-11 (96906)	EA	4	*	*	*	*				4	10
-P-0-	310-651-2674	NUT, PLAIN, HEXAGON MS35691-1 (96906)	EA	4	REF	RE	REF	RE		R	R	4	11
-P-F-	305-543-5198	CREW, MACHINE S35265-36 (96906)	EA	2	*	*	*	*				5	1
X1---		PACER G2205 (96073)		2								5	2
-P-F-	310-042-1404	ASHER, FLAT S27183-6 (96906)	EA	2	*	*	*	*				5	3
-P-F-	310-045-4007	ASHER, LOCK S35338-41 (96906)	EA	6	*	*	*	*				5	4
-P-F-	310-934-9747	UT, PLAIN, HEXAGON S35649-262 (96906)	EA	6	*	*	*	*				5	5
-P2F-	431-451-0999	TABILIZER ASSEMBLY 1G2211 (96073)	EA	1	*	*	*	*				5	6
X2-F-		PANEL, FILTER 8G2286 (96073)	EA	1								5	7
-P-F-		CAPACITOR, FILTER KTL16U306Q (09023)	EA	1	1	3	1	1					8
X2-F-		BRACKET, MOUNTING 30393-9 (09023)	EA	1									9
-P-F-	305-582-5607	SCREW, MACHINE MS35265-28 (96906)	EA	4	*	*	*	*					10
-P-F-	305-549-5335	RESISTOR, FIXED, WIREWOUND RW29V102 (81349)	EA	1	1		1	1					11

SECTION II REPAIR PARTS FOR DIRECT SUPPORT, GENERAL SUPPORT, AND DEPOT MAINTENANCE

(CONTINUED)

(1) SMR CODE	(2) FEDERAL STOCK NUMBER	DESCRIPTION REFERENCE NUMBER & MFR. CODE	USABLE ON CODE	(5) QTY REQ UNIT	(6) 30-DAY DS MAINT ALLOWANCE			(7) 30-DAY GS MAINT ALLOWANCE			(8) 1 Y WPE QUI WTGC	(9) EP AI W LO DU	(10) ACTIONS	
					(a) -20	(b) -10	(c) -10	(a) -20	(b) -50	(c) -10			(a) NO	(b) ITEM NO.
-P2F-	150-451-8386	LEAD ASSEMBLY U14-12S475 (96073)			*		*	*	*	*				12
-P2F-	150-469-2337	LEAD ASSEMBLY U14-13X475 (96073)			*		*	*	*	*				13
-P-F-	340-782-8737	CLIP NAS1397P4N (80225)			1		4	1	2	4				14
-P-F-	305-1 00-4611	RESISTOR, FIXED, WI REWOUND 0400C (44655)			1		3	1	1	3				15
-P-F-	310-851-2682	NUT, PLAIN, HEXAGON IS35691-17 (96906)		1	*		*	*	*	*				1
-P-F-	310-637-9541	WASHER, LOCK IS35338-46 (96906)		1	*		*	*	*	*				2
-P-F-	130-451-1642	RECTIFIER ASSEMBLY 7G1586 (96073)			*		1	*	1	1				3
11---		ROD 13 R1142 (96073)												4
11---		PLATE 11 G1587A (96073)												5
-P-0-	310-477-0332	WASHER, NONMETALLIC 1-562-125-910 (34463)			1		3	1	1	3	30			6
-P-0-	310-809-4061	WASHER, FLAT MS27183-15 (96906)			*		*	*	*	*	1			7
-P-F-		DIODE, SILICONE D279S5330 (58849)			1		4	1	2	4				8
-P-0-	310-851-2674	NUT, PLAIN, HEXAGON MS35691-1 (96906)			REF	RI	REF	REF	REF	REF	REF	RI	RI	9
-P-0-	305-021-3616	SCREW, CAP, HEXAGON HEAD MS35307-305 (96906)			REF	RI	REF	REF	REF	REF	REF	RI	RI	10
-P2F-	310-472-3582	CAPACITOR AND TERM STRIP ASSY 4G1216 (96073)			*		*	*	*	*				11
-P-F-	305-582-5807	SCREW, MACHINE MS35265-28 (96906)			REF	RI	REF	REF	REF	REF	REF	RI	RI	12
-P-F-		TERMINAL STRIP, GROUNDING 864 (85330)			*		2	*	1	2				13
-P-F-	910-577-1138	CAPACITOR, FIXED CERAMIC BYPASS 5HKS10 (56289)			1		3	1	2	3				14
-P-F-	310-045-4007	WASHER, LOCK MS35338-41 (96906)			REF	RI	REF	REF	REF	REF	REF	RI	RI	15
-P-F-	310-934-9747	NUT, PLAIN, HEXAGON MS35649-62 (96906)			REF	RI	REF	REF	REF	REF	REF	RI	RI	16
X1---		WIRE, ELECTRICAL 18 AWG BLACK B18-4 (96073)												17
11---	940-156-7135	TERMINAL, LUG 31256 (00779)												18
-P20-	150-451-1239	BUS BAR P/N11G1284 (96073)			*		*	*	*	*				19
-P-0-	310-582-5965	WASHER, LOCK MS35338-44 (96906)			REF	RI	REF	REF	REF	REF	REF	RI	RI	20

SECTION II REPAIR PARTS FOR DIRECT SUPPORT, GENERAL SUPPORT, AND DEPOT MAINTENANCE (CONTINUED)

(1) SMF CODE	(2) FEDERAL STOCK NUMBER	(3) DESCRIPTION REFERENCE NUMBER & MFR. CODE	(4) UNIT OF MEAS	(5) QTY NC I UNIT	(6)			30 GS OWA	INT	(8) Y W P EQUI VTGC	(9) EPO AIN WP 100 QUIL	(10) RATIONS		
					(a) 1-2	(b) 1-5	(c) 1-1					(a) 1-1	(b) ITEM NO.	
		BASE ASSEMBLY (See II, Fig. I)		REF								7	1	
-P-F	5306-958-1148	SCREW, CAP, HEXAGON HEAD MS35307-348 (96906)	EA	1	*	*	*	*	*	1	1	7	2	
X1--		BLOCK COIL 8G149 (96073)		1								7	3	
-P-F	5310-934-9747	NUT, PLAIN, HEXAGON MS35649-62 (96906)	EA	4	REF	REF	REF	REF	REF	REF	REF	7	4	
-P-F	5310-045-4007	WASHER, LOCK MS35338-41 (96906)	EA	4	REF	REF	REF	REF	REF	REF	REF	7	5	
-P-F	5305-582-5808	SCREW, MACHINE MS35265-31 (96906)	EA	2	*	*	*	*	*	1	1	7	6	
-P-F	5950-472-3579	COIL TESLA 26G2285-2 (96073)	EA	1	*	*	1	*	*	1	10	7	7	
X1--		INSULATOR COIL TESLA 8G2287 (96073)		1								7	8	
X1--		BLOCK 8G2156 (96073)		1								7	9	
-P-O	5305-719-3997	SCREW, CAP, HEXAGON HEAD MS35307-303 (96906)	EA	3	*	*	*	*	*	1	1	7	10	
X2-0		BUS BAR 29 G1986-1 (96073)	EA	1								7	11	
-P-O	5310-582-5965	WASHER, LOCK MS35338-44 (96906)	EA	26								7	12	
-P-O	5310-851-2674	NUT, PLAIN, HEXAGON MS 35691-1 (96906)	EA	16	REF	REF	REF	REF	REF	REF	REF	7	13	
-P-F	5310-809-4061	WASHER, FLAT MS27183-15 (96906)	EA	1	REF	REF	REF	REF	REF	REF	REF	7	14	
-P-F	5310-407-9566	WASHER, LOCK MS35338-45 (96906)	EA	2	*	*	*	*	*	1	1	7	15	
-P-F	5310-891-1709	NUT, PLAIN, HEXAGON MS35691-9 (96906)	EA	1	*	*	*	*	*	1	1	7	16	
(2-F)		TERMINAL, LUG S09131 (26132)	EA	2								7	17	
(2-F)		TERMINAL, LUG R1170S (26132)	EA	1								7	18	
(2-F)		TERMINAL LUG S1256 (00779)	EA	1								7	19	
-P-F	5910-455-0851	CAPACITOR 6N8F50602 (81133)	EA	1	1	1	3	1	1	3	30	50	7	20
-P-F	5305-757-8287	SCREW, TAPPING, THREAD FORMING MS51851-43 (96906)	EA	4	REF	REF	REF	REF	REF	REF	REF	7	21	
-P-O	5305-940-9426	SCREW, CAP, HEXAGON HEAD MS35309-357 (96906)	EA	2	*	*	*	*	*	1	1	7	22	
-P-O	5310-637-9541	WASHER, LOCK MS35338-46 (96906)	EA	2	REF	REF	REF	REF	REF	REF	REF	7	23	
(2-0)		BUS BAR 29 G1986-7 (96073)	EA	1								7	24	
-P-F	5307-472-9886	STUD 11G1705A (96073)	EA	2	*	1	2	*	1	2	20	50	7	25
-P-F	6110-451-1241	PANEL SECONDARY 8G1286 (96073)	EA	1	*	*	*	*	*	5	5	7	26	
(2-0)		PLATE, IDENTIFICATION 14R771 (96073)	EA	1				*				7	26A	
(2-0)		PLATE, IDENTIFICATION 14R109 (96073)	EA	1								7	26B	

SECTION II REPAIR PARTS FOR DIRECT SUPPORT, GENERAL SUPPORT, AND DEPOT MAINTENANCE (CONTINUED)

(1) SMR CODE	(2) FEDERAL STOCK NUMBER	(3) DESCRIPTION REFERENCE NUMBER & MFR. CODE	(4) UNIT OF MEAS USABLE ON CODE	(5) QTY NC IN UNIT	(6)			(7)			(8) YR LW PE EQUIP NTGCT	(9) EPOT AINT WPER 100 JUIP	LLU (a) FIG NO.)) ATIONS (b) ITEM NO.
					30- (a) -20	Y DS (b) -50	INT (c) -10	30- (a) -20	GS OWAN (b) -50	NT (c) -100				
P-F--		WASHER, NONMETALLIC 1-562-125-910 (34463)	EA	2	REF	REF	REF	REF	REF	REF	REF	REF	7	27
P-F--	5310-584-5272	WASHER, LOCK MS35338-48 (96906)	EA	2	*	*	*	*	*	*	1	1	7	28
P-F--		NUT, JAM MS51970-5 (96906)	EA	4	*	*	*	*	*	*	1	1	7	29
P-0--	5310-913-5472	SCREW, CAP, HEXAGON HEAD MS35307-305 (96906)	EA	3	REF	REF	REF	REF	REF	REF	REF	REF	7	30
2-0--		BUS BAR 29G1986-6 (96073)	EA	1									7	31
2-0--		FUSEHOLDER ASSEMBLY 11G2209 (96073)	EA	1									7	32
2-0--	5920-217-9118	FUSEHOLDER HKP (71400)	EA	1									7	33
P-0--	5920-280-9539	FUSE, CARTRIDGE 20 AMP 250 VOLT 314020 (75915)	EA	1	1	2	4	1	2	4	50	50	7	34
P20--	5150-451-8388	LEAD ASSEMBLY W14-25S441 (96073)	EA	1	*	*	*	*	*	*	5	10	7	35
P-F--	5310-934-9757	NUT, PLAIN, HEXAGON MS35649-282 (96906)	EA	6	*	*	*	*	*	*	1	1	7	36
P-F--	5310-045-3296	WASHER, LOCK MS35338-43 (96906)	EA	2	REF	REF	REF	REF	REF	REF	REF	REF	7	37
2-F--		PLATE, RELAY MOUNTING 13 G2410 (96073)	EA	1									7	38
P-H--	5310-609-8544	WASHER, FLAT MS27183-7 (96906)	EA	8	*	*	*	*	*	*	1	1	7	39
P-F--		RELAY OVERLOAD HCC1-617XXA (74193)	EA	1	1	1	2	1	1	2	25	30	7	40
P-F--	5305-660-2625	SCREW, MACHINE MS35265-47 (96906)	EA	6	*	*	*	*	*	*	1	1	7	41
P-H--	5431-083-2655	TRANSFORMER 637-003-685 (75138)	EA	1	*	*	1	*	*	1	10	10	7	42
2-H--	5940-236-0575	TERMINAL, LUG MS25036-154 (96906)	EA	2									7	43
P-0--	5306-011-6549	SCREW, CAP, HEXAGON HEAD MS35309-34 (96906)	EA	1	*	*	*	*	*	*	1	1	7	44
P-0--	5310-903-3996	NUT, PLAIN, HEXAGON MS51969-2 (96906)	EA	2	*	*	*	*	*	*	1	1	7	45
P-F--	5310-889-2528	WASHER, LOCK MS45904-68 (96906)	EA	2	*	*	*	*	*	*	1	1	7	46
P-0--	5310-924-4218	NUT, PLAIN, HEXAGON MS51970-1 (96906)	EA	28	*	*	*	*	*	*	1	1	7	47
P20--	5940-432-7437	LINK, VOLTAGE CHANGE 11G2229 (96073)	EA	4	*	*	1	*	*	1	10	10	7	48
P-0--	5305-080-7336	SCREW, MACHINE MS35265-86 (96906)	EA	2	*	*	*	*	*	*	1	1	7	49
P-0--	5310-809-4058	WASHER, FLAT MS27183-10 (96906)	EA	2	*	*	*	*	*	*	1	1	7	50
2-0--		TERMINAL BOARD 8R2301 (96073)	EA	1									7	51
P-0--	5305-550-3934	SCREW, CAP, HEXAGON HEAD MS35309-308 (96906)	EA	14	*	*	*	*	*	*	1	1	7	52
P-F--	5305-717-5467	SCREW, CAP, HEXAGON HEAD MS35307-362 (96906)	EA	1	*	*	*	*	*	*	1	1	7	53
2-H--	5940-114-1306	TERMINAL, LUG MS25036-17 (96906)	EA	1									7	54

SECTION REPAIR PARTS FOR DIRECT SUPPORT, GENERAL SUPPORT, AND DEPOT MAINTENANCE (CONTINUED)

(1) SMR CODE	(2) FEDERAL STOCK NUMBER	(3) DESCRIPTION REFERENCE NUMBER & MFR. CODE	USABLE ON CODE	(4) UNIT OF MEAS	(5) QTY INC IN UNIT	(6) 30-DAY DS MAINT ALLOWANCE			(7) 30-DAY GS MAINT ALLOWANCE			(8) 1 YR ALW PER EQUIP CNTGCTY	(9) DEPOT MAINT ALW PER 100 EQUIP	(10) ILLUSTRATIONS	
						(a) 1-20	(b) 21-50	(c) 51-100	(a) 1-20	(b) 21-50	(c) 51-100			(a) FIG NO.	(b) ITEM NO.
2-H--	5940-113-9425	TERMINAL, LUG R3461 (26132)		EA	3									7	55
P-F--	5310-082-1404	WASHER, FLAT MS27183-6 (96906)		EA	2	REF	REF	REF	REF	REF	REF	REF	REF	7	56
P-F--	6130-451-6141	RECTIFIER, CONTROL EHS3BI (58849)		EA	1	*	*	1	*	*	1	10	10	7	57
P-F--	5305-628-9474	SCREW, MACHINE MS35265-35 (96906)		EA	2	*	*	*	*	*	*	1	1	7	58
P-0--	5305-543-5828	SCREW, CAP, HEXAGON HEAD MS35309-306 (96906)		EA	2	*	*	*	*	*	*	1	1	7	59
P-0--	6150-451-1240	BUS BAR-E 11 G2200 (96073)		EA	2	*	1	2	*	1	2	20	40	7	60
P-F--	5305-579-2139	SCREW, MACHINE MS35265-30 (96906)		EA	4	*	*	*	*	*	*	1	1	7	61
P-F--		RELAY, POWER ACC330U9 (04009)		EA	1	*	*	1	*	*	1	10	20	7	62
		GROUP 04 -ELECTRICAL CONTROLS AND ASSOCIATED PARTS													
		HOUSING, FRONT (See 8, Fig. 1)		REF										8	1
P-F--	5310-582-5965	WASHER, LOCK MS35338-44 (96906)		EA	8	REF	REF	REF	REF	REF	REF	REF	REF	8	2
P-F--	5305-080-7336	SCREW, MACHINE MS35265-86 (96906)		EA	2	REF	REF	REF	REF	REF	REF	REF	REF	8	3
2-F--	5355-613-9740	KNOB 5104 (44655)		EA	1									8	4
P-F--	5305-719-3997	SCREW, CAP, HEXAGON HEAD MS35307-303 (96906)		EA	6	REF	REF	REF	REF	REF	REF	REF	REF	8	5
P20--		HANDLE, SWITCH 1G1989 (96073)		EA	2	*	*	*	*	*	*	5	10	8	6
P-0--		PIN, ROLL 7R2036-187X1 (96073)		EA	2	1	2	4	1	2	4	50	100	8	7
2-F--		PLATE, IDENTIFICATION 14R2334 (96073)		EA	1									8	8
P-F--		SWITCH, RANGE 24G1596-2 (96073)		EA	1	*	*	1	*	*	1	10	10	8	9
2-0--		BUS BAR 29G1986-4 (96073)		EA	1									8	10
P-0--		SCREW, CAP, HEXAGON HEAD MS35309-306 (96906)		EA	2	REF	REF	REF	REF	REF	REF	REF	REF	8	11
2-0--		BUS BAR 29G1986-3 (96073)		EA	1									8	12
P-0--	5310-087-7493	WASHER, FLAT MS27183-13 (96906)		EA	2	*	*	*	*	*	*	1	1	8	13
P-0--	5310-051-2674	NUT, PLAIN, HEXAGON MS35361-1 (96906)		EA	2	REF	REF	REF	REF	REF	REF	REF	REF	8	14
P-F--		SWITCH, POLARITY 24G1596-1 (96073)		EA	1	*	*	1	*	*	1	10	20	8	15
2-0--		BUS BAR 29 G1986-5 (96073)		EA	1									8	16
2-0--		BUS BAR 29G1986-2 (96073)		EA	1									8	17
P-F--	5910-452-0948	CAPACITOR ASSEMBLY 4G1228 (96073)		EA	1	*	1	2	*	1	2	20	30	8	18
P-F--	5910-985-0457	CAPACITOR P/N MKML647 (09023)		EA	1	*	1	2	*	1	2	20	30	8	19

SECTION II REPAIR PARTS FOR DIRECT SUPPORT, GENERAL SUPPORT, AND DEPOT MAINTENANCE (CONTINUED)

(1) SMR CODE	FEDERAL STOCK NUMBER	(3) DESCRIPTION REFERENCE NUMBER & MFR. CODE	USABLE CODE	(4) UP ME	(5) Q UN	(6) 30-DAY DS MAINT ALLOWANCE						(8) Y ALW P EQUI CNTG	(9) EF W TO QU	ILL F Ni	RATION (b) ITEM NO.	
						(1)	(2)	(3)	(4)	(5)	(6)					
P-F--	365-477-030	RESISTOR, VARIABLE 144493C (44655)		I								35	5		20	
P2F--		PACER 3G2189 (96073)		I								5			21	
P2F--		ACK ASSEMBLY, BANANA 08-0902 (74970)		I								5			22	
P-F--	305-582-580	CREW, MACHINE S35265-28 (96906)		E		RE	RE	REI	REI	EF	EF	REF	EF		1	
2-F--		RAWER ASSEMBLY, HIGH FREQUENCY 2G1780FED (96073)		E											2	
P-F--		SCREW, MACHINE MS35265-47 (96906)		E		RE	RE	REI	REI	EF	EF	REF	EF		3	
P2F--	431-451-100	DRAWER 3G1823 (96073)		E					*	*	*	5	10		4	
P-F--	305-755-243	RESISTOR RP151FD2R0KK (81349)		E			2	*	1	2	20	50			5	
2-0--		PLUG, BANANA, INSULATED 108-0302 (74970)		E											6	
2-(PLUG AND GAP ASSEMBLIES 264-11-02-030-5A (71785)		E		1								9	7	
P2I	35-452-095	DUMMY PLUG 9G1646-3 (96073)		E		1	*	*	*	*	*	5	0	9	8	
1--		WIRE, Electrical 18AWG WHITE W18 (96073)				2								9	9	
2-C	5935-303-069	CONNECTOR, PLUG, Electrical 86CP8 (02660)		EA		1								9	10	
2-F		KNOB, 5150 (44655)		EA		1								9	11	
2F	5935-222-993	SOCKET, ELECTRON TUBE 7858 (02660)		EA		4	*	*	*	*	*	5	10	9	12	
1-F	5310-809-406	WASHER, FLAT MS27183-15 (96906)		EA		2	IF	IF	IF	F	F	EF	EF	9	13	
1-0		LOCK, DOOR MS425C-S (74842)		EA		1								9	14	
0	5930-797-373	SWITCH, TOGGLE SPST MH20994LG (04009)		EA		4	1	1	3	1	1	3	30	50	9	15
0		DECAL 4 R2306 (96073)		EA		1									16	
0-	5930-646-436	SWITCH, MICRO-POWER 3AT1 (91929)		EA		1	*	1	2	*	1	2	20	30	9	17
20-	6210-469-6714	LIGHT, INDICATOR 100-202-323 (72765)		A		3	*	*	*	*	*	5	15	9	18	
0-	6240-682-3411	LAMP NES1H (08805)		A		3	1	2	4	1	2	1	30	15	9	19
0-		CAP AND NUT ASSEMBLY LIGHT INDICATOR 25 P52B323 (72765)		A		3	*	1	2	*	*	10	0	9	20	
20-	3431-134-8104	PARK GAP ASSEMBLY 1G2243 (96073)		A		1	*	*	*	*	*	5	0	9	21	
0-	5305-207-2297	SCREW, CAP, HEXAGON HEAD MS35307-312 (96906)		A		2	*	*	*	*	*	1	1	9	22	

SECTION II REPAIR PARTS FOR DIRECT SUPPORT, GENERAL SUPPORT, AND DEPOT MAINTENANCE (CONTINUED)

(1) SMR CODE	(2) FEDERAL STOCK NUMBER	(3) DESCRIPTION REFERENCE NUMBER & MFR. CODE	(4) UNIT OF MEAS	(5) QTY INC UNIT	(6) 30-DAY DS MAINT ALLOWANCE			(7) 30-DAY GS ALLOWANCE			(8) I YI W PE EQUI NTGC	(9) DEPO MAINT LW PE 100 QUIF	(10) CONDITIONS	
					(a) 1-20	(b) 1-5	(c) 1-10	(a) 1-20	(b) 1-5	(c) 1-10			(a) FIG NO.	(b) ITEM NO.
P-0-	310-809-3078	WASHER, FLAT MS27183-11 (96906)	EA	4	REF	REF	REF	REF	REF	REF	REF	9	23	
P-0-	310-477-0333	WASHER 8R2306 (96073)	EA	8	1	2	4	1	2	4	50	100	9	24
P-0-	305-582-5807	SCREW, MACHINE MS35265-28 (96906)	EA	REF	REF	REF	REF	REF	REF	REF	REF	REF	9	25
P-0-	305-716-6312	SCREW 11R1209 (96073)	EA	2	1	2	4	1	2	4	50	100	9	26
P-0-	431-451-1000	BRIDGE, SPARK GAP 11G2241 (96073)	EA	2	1	2	3	1	2	3	40	50	9	27
P-0-	305-716-6313	SCREW 11R139 (96073)	EA	2	1	2	4	1	2	4	50	100	9	28
Z-0-		TUBE 8G2305 (96073)	EA	2									9	29
P-0-	431-451-6010	PLATFORM 11G2242 (96073)	EA	1	*	*	1	*	*	1	10	20	9	30
P-0-		WASHER, LOCK MS35338-44 (96906)	EA	2	REF	REF	REF	REF	REF	REF	REF	REF	9	31
P-0-	310-851-2674	NUT, PLAIN, HEXAGON MS35641-1 (96906)	EA	2	REF	REF	REF	REF	REF	REF	REF	REF	9	32
P-F-		SCREW, MACHINE ANS02-10-12 (88044)	EA	1	*	*	*	*	*	*	1	1	9	33
Z-0-		BRACKET, SPARK GAP 13G1833 (96073)	EA	1									9	34
P-F-		NUT, PLAIN, HEXAGON MS35649-82 (96906)	EA	9	REF	REF	REF	REF	REF	REF	REF	REF	9	35
P-F-		WASHER, LOCK MS35338-43 (96906)	EA	9	REF	REF	REF	REF	REF	REF	REF	REF	9	36
P-F-		CAPACITOR, HV 11GL (09023)	EA	1	1	2	3	1	2	3	40	50	9	37
X2-F-	940-143-4780	TERMINAL, LUG MS35036-108 (96906)	EA	4									9	38
P-F-	310-082-1404	WASHER, FLAT MS27183-6 (96906)	EA	4	REF	REF	REF	REF	REF	REF	REF	REF	9	39
P-F-	310-186-7454	WASHER, LOCK MS35338-41 (96906)	EA	6	REF	REF	REF	REF	REF	REF	REF	REF	9	40
P-F-	310-013-4530	NUT, PLAIN HEXAGON MS35649-62 (96906)	EA	6	REF	REF	REF	REF	REF	REF	REF	REF	9	41
P-F-	950-472-3562	TRANSFORMER 169-001-759 (75138)	EA	1	*	1	1	*	1	1	15	20	9	42
P-F-	310-809-8544	WASHER, FLAT MS27183-7 (96906)	EA	8	REF	REF	REF	REF	REF	REF	REF	REF	9	43
P-F-	945-472-3556	RELAY POWER CONTROL M110-2G24A (22039)	EA	2	1	2	4	1	2	4	50	00	9	44
P-F-	305-582-5808	SCREW, MACHINE MS35265-31 (96906)	EA	2	REF	REF	REF	REF	REF	REF	REF	REF	9	45
X2-F		BRACKET, MOUNTING 13G2409 (96073)	EA	1									9	46
X2-F		LAMP, CABLE 160387AD4-824 (78553)	EA	2									9	47
X2-F		PLATE, MOUNTING 3G2308 (96073)	EA	1									9	48
P-F	305-614-0267	SCREW, MACHINE MS35265-34 (96906)	EA	4	*	*	*	*	*	*	1	1	9	49

SECTION , REPAIR PARTS FOR DIRECT SUPPORT, GENERAL SUPPORT, AND DEPOT MAINTENANCE (CONDENSED)

(1) SMR CODE	(2) FEDERAL STOCK NUMBER	(3) DESCRIPTION REFERENCE NUMBER & MFR. CODE	(4) UNIT OF MEAS	(5) QTY INC IN UNIT	(6) 30-DAY DS MAINT ALLOWANCE			(7) 30-DAY GS MAINT ALLOWANCE			(8) YR ALW PER EQUIP CNTGCT	(9) DEPOT MAINT ALW PE 100 EQUIP	(10) ILLUSTRATIONS	
					(a)	(b)	(c)	(a)	(b)	(c)			(a)	(b)
					1-20	21-50	51-100	1-20	21-50	51-100			FIG NO.	ITEM NO.
X2-0--		INSULATOR , SWITCH 8G2311 (96073)	EA	1								9	50	
-P-0--	5930-543-0839	SWITCH, BASIC P/NYZ2RD (91929)	EA	1	*	1	2	*	1	2	20	50	9	51
-P-F--	5975-074-2072	STRAP SST2 (06383)	EA	5	1	2	4	1	2	4	50	100	9	52
X2-F--		CLAMP, CABLE C60387AD10-824 (78553)	EA	2									9	53
-P-0--	5945-452-0944	TIMER CHB38-31005 (77342)	EA	2	*	1	2	*	1	2	20	40	9	54
-P2F--	3431-451-6011	WIRING HARNESS 29 G2037 (96073)	EA	1	*	*	*	*	*	*	5	10	10	1
-P20--		CONNECTOR, RECEPTACLE, ELECTRICAL 264-12-02-013-1A (71785)	EA	1	*	*	*	*	*	*	5	10	10	2
-P-0--	5930-410-6136	SWITCH, TOGGLE SPST AH20994LG (04009)	EA	1	REF	REF	REF	REF	REF	REF	REF	REF	10	3
X2-0--		TERMINAL, LUG S09131 (26132)	EA	6									10	4
-P-F--	5935-257-6397	CONNECTOR, RECEPTACLE, ELECTRICAL 2475 (77881)	EA	1	*	1	2	*	1	2	20	40	10	5
-P20--	5940-245-5949	TERMINAL, LUG 30997 (00779)	EA	7	*	*	*	*	*	*	5	70	10	6
X2-0--	5940-143-4780	TERMINAL, LUG MS25036-108 (96906)	EA	10	REF	REF	REF	REF	REF	REF	REF	REF	10	7
-P-0--	5930-472-3578	THERMOSTAT ASSEMBLY 24G2012 (96073)	EA	1	*	1	2	*	1	2	20	30	10	8
X1----		THERMOSTAT 9700L276-216 (73803)	EA	1									10	9
-P-0--	5935-581-1073	JACK, PIN 78-1L (02660)	EA	2	*	*	1	*	*	1	10	20	10	10
X2-0--		TERMINAL, LUG 31256 (00779)	EA	2	REF	REF	REF	REF	REF	REF	REF	REF	10	11
-P-0--		SWITCH, TOGGLE 80600BJ (04009)	EA	1	*	1	2	*	1	2	20	40	10	12
-P2F--	5945-259-5579	PI LOT RECTIFIER AND RELAY ASSEMBLY 18G1854 (96073)	EA	1	*	*	*	*	*	*	5	10	11	1
-P-0--		NUT, PLAIN, HEXAGON MS35649-62 (96906)	EA	9	REF	REF	REF	REF	REF	REF	REF	REF	11	2
-P-0--		WASHER, FLAT MS27183-6 (96906)	EA	3	REF	REF	REF	REF	REF	REF	REF	REF	11	3
-P-0--		WASHER, LOCK MS35338-41 (96906)	EA	7	REF	REF	REF	REF	REF	REF	REF	REF	11	4
-P-F--	6130-557-7153	RECTIFIER, METALLIC D3575F (81483)	EA	1	*	*	1	*	*	1	10	20	11	5
X2-F--		INSULATOR FIBRE 8G2280 (96073)	EA	1									11	6
X2-F--		BRACKET, MOUNTING 13G2324 (96073)	EA	1									11	7
-P-0--	5305-514-7506	SCREW, MACHINE MS35265-26 (96906)	EA	2	*	*	*	*	*	*	1	1	11	8
-P-F--	5945-259-5579	RELAY PR5AY24VSPDT (77342)	EA	2	*	1	2	*	1	2	20	50	11	9
-P-F--	6150-469-2342	LEAD ASSEMBLY P18-5-1-2S2210 (96073)	EA	1	*	*	1	*	*	1	10	50	11	10

SECTION 11 REPAIR PARTS FOR DIRECT SUPPORT, GENERAL SUPPORT, AND DEPOT MAINTENANCE (CONTINUED)

(1) SMR CODE	(2) FEDERAL STOCK NUMBER	DESCRIPTION REFERENCE NUMBER & MFR. CODE	USABLE ON CODE	(4) UNIT OF MEAS	(5) QTY NC 1 UNIT	(6) 30-DAY DS MAINT ALLOWANCE			(7) 30-DAY GS ALLOWANCE			(8) I YF W PE QUIT YTOC	(9) EPO AIN W PI 100 QUIT	LLU (a) FIG NO.	O) ATIONS (b) ITEM NO.
						(a) 1-20	(b) 1-5	(c) 1-1	(a) 1-20	(b) 1-5	(c) 1-10				
P-F--	5150-469-2336	LEAD ASSEMBLY N18-5-2210-2210 (96073)		EA	1	*	*	1	*	*	1	10	50	11	11
P-F-	5945-472-3556	RELAY PILOT KN1152C1OKS (22039)		EA	1	*	1	2	*	1	2	20	30	11	12
P-F-	5150-451-8393	LEAD ASSEMBLY N18-11S2210 (96073)		EA	1	*	*	1	*	*	1	10	50	11	13
P-F-	5150-451-8385	LEAD ASSEMBLY W14-15S441 (96073)		EA	1	*	*	1	*	*	1	10	50	11	14
P-F--	5150-468-2340	LEAD ASSEMBLY B18-3S2210 (96073)		EA	1	*	*	1	*	*	1	10	50	11	15
P-F--	5150-469-2336	LEAD ASSEMBLY B18-6-2210-2210 (96073)		EA	2	*	*	1	*	*	1	10	50	11	16
P-F--	945-027-4278	RELAY KCP112500-2 (77342)		EA	1	*	1	2	*	1	2	20	30	11	17
P2F--	5935-222-9932	SOCKET, ELECTRON TUBE 78S8 (02660)		EA	2	EF	EF	EF	EF	EF	EF	REF	REF	11	18
P-F--	5150-451-8387	LEAD ASSEMBLY B14-13S441 (96073)		EA	1	*	*	1	*	*	1	10	50	11	19
P-O--	5930-655-1515	SWITCH DPDT 82605 (04009)		EA	1	*	1	1	*	1	1	15	25	11	20
P-F--	5150-451-8392	LEAD ASSEMBLY W14-23S441 (96073)		EA	1	*	*	1	*	*	1	10	50	11	21
P-O-		SCREW, MACHINE MS35265-31 (96906)		EA	4	EF	EF	EF	EF	EF	EF	REF	REF	11	22
P-F--	5910-079-3761	CAPACITOR, FIXED BR500-50 (09023)		EA	1	1	1	2	1	1	2	25	50	11	23
P-F--	5961-417-7096	SEMICONDUCTOR DEVICE, DIODE 1N4723 (04713)		EA	1	*	*	1	*	*	1	10	25	11	24
P-O--		SCREW, MACHINE MS35265-36 (96906)		EA	1	EF	EF	EF	EF	EF	EF	REF	REF	11	25
P-F--	5150-469-2350	LEAD ASSEMBLY B18-11S475 (96073)		EA	1	*	*	1	*	*	1	10	50	11	26
P-F--		RESISTOR, FIXED 4700-12W (44655)		EA	1	1	1	2	1	1	2	25	50	11	27
P-F--	5305-582-5807	SCREW MACHINE S35265-28 (96906)		EA	2	EF	EF	EF	EF	EF	EF	REF	REF	11	28
GROUP 05 -HYDRAULICCOMPONENTS															
P-O--		VALVE ASSEMBLY, GAS AND WATER 2G1839-1 (96073)		EA	1	1	1	2	1	1	2	15	25	12	1
2-0--	+730-301-7470	ADAPTER 3200X4 (79470)		EA	1									12	2
2-0--	5310-088-5285	WASHER, FLAT MS27183-20 (96906)		EA	8	*	*	*	*	*	*	1	1	12	3
2-0--	+730-932-1010	ADAPTER 15A (16166)		EA	2									12	4
2-0--		ADAPTER AW15 (16166)		EA	1									12	5
20--	5935-171-3001	PLUG, PIN 71-1L (02660)		EA	2	*	*	*	*	*	*	5	5	12	6
2-0--		VALVE, SOLENOID 8262C22 (04845)		EA	2	*	1	2	*	1	2	20	30	12	7
20--		ELBOW, PIPE 22 R1759 (96073)		EA	4	*	*	*	*	*	*	5	50	12	8

SECTION II REPAIR PARTS FOR DIRECT SUPPORT, GENERAL SUPPORT, AND DEPOT MAINTENANCE

(CONTINUED)

S CO	FEDERAL STOCK NUMBER	(3) DESCRIPTION REFERENCE NUMBER & MFR. CODE	USABLE CODE	(4) U M	(5) QTY NC I UNIT	(6) 30-DAY DS MAJ ALLOWANCE		(7)		(8) ILL EQ CNT	ILL (F N	(9) RATIO (b) ITEM NO.
						(a) 1-2C	(b) 1-5C					
P-0	325-290-43	GROMMET, RUBBER 913 (75543)		E	1			2		10	11	9
2-0		PLATE, MOUNTING 3G1831 (96073)		E	1						12	10
P-0		CREW, TAPPING, THREAD FORMING IS51851-43 (96906)		E	4	EF		EF		RE	12	11
		GROUP 06 REMOTE CONTROL										
20		OOT CONTROL, TYPE D 0-904 (82807)		E	1	*		*			13	1
2F		COVER ASSEMBLY 21-932 (82807)		E	1	*		*			13	2
2F		TREADLE ASSEMBLY 21-905 (82807)		E	1	*		*			13	3
-F-		SCREW, CAP, HEXAGON HEAD MS35307-376 (96906)		E	1	*		*			13	4
-F-		NUT, PLAIN, HEXAGON MS35649-62 (96906)		A	2	EF		EF		REF	13	5
-F-		WASHER, LOCK MS35338-41 (96906)		A	2	EF		EF		REF	13	6
-F-		NUT, PLAIN, HEXAGON MS35681-1 (96906)		A	4	EF		EF		REF	3	7
-F-		WASHER, LOCK MS35338-44 (96906)		A	4	EF		F		REF	3	8
2F-	360-472-798	SPRING 21-929 (82807)		A	1	*		*		5	3	9
-F-		SCREW, CAP, HEXAGON HEAD MS35-309-306 (96906)		A	2	F		F		REF	3	10
-F-		RHEOSTAT ASSEMBLY 20-008 (82807)		A	1	1		1		25	3	11
-F-		RHEOSTAT ASSEMBLY, RIGHT 21-213R (82807)		A	1	1		1		25	3	12
-F-	10-476-758	NUT, PLAIN, HEXAGON 11-210-005 (82807)		A	1	*		*		1	3	13
-F-	10-476-750	WASHER, LOCK 11-214-003 (82807)		A	1	*		*		1	3	14
-F-		LEAD, ELECTRICAL 21-023-001 (82807)		A	1						3	15
F-	305-716-628	SCREW, MACHINE, BRUSHHOLDER 11-200-057 (82807)		A	1	*		*		1	3	16
F		LEAD, ELECTRICAL 21-023-005 (82807)		A	1						5	17
P-F--	377-451-837	BRUSH ASSEMBLY, CARBON 21-038 (82807)		A	1			1		25	5	18
1----		HOLDER, BRUSH ASSEMBLY 21-035 (82807)		A	1							19
2-F--		PLATE, MOUNTING 21-040 (82807)		A	1						3	20
1-F--	305-954-8157	SCREW, MACHINE MS35215-65 (96906)		A	1			*		1	3	21
1-F--		RHEOSTAT ASSEMBLY, LEFT 21-213L (82807)		A	1			1		5	3	22
-F--		PIN, RHEOSTATS MOUNTING 21-064 (82807)		A	1						3	23

SECTION II REPAIR PARTS FOR DIRECT SUPPORT, GENERAL SUPPORT, AND DEPOT MAINTENANCE (CONTINUED)

(1) SMR CODE	(2) FEDERAL STOCK NUMBER	(3) DESCRIPTION REFERENCE NUMBER & MFR. CODE	(4) UNIT OF MEAS	(5) QTY INC IN UNIT	(6) 30-DAY DS MAINT ALLOWANCE			(7) 30-DAY GS MAINT ALLOWANCE			(8) 1 YR ALW PER EQUIP CNTGCT	(9) DEPOT MAINT ALW PER 100 EQUIP	(10) ILLUSTRATIONS	
					(a)	(b)	(c)	(a)	(b)	(c)			(a)	(b)
					1-20	21-50	51-100	1-20	21-50	51-100			FIG NO.	ITEM NO.
2-F--		PLATE, MOUNTING, FRONT 21-039 (82807)	EA	1								13	24	
P-F--	5310-476-7521	WASHER, LOCK 11-214-005 (82807)	EA	2	*	*	*	*	*	*	1	1	13	25
P-F--		NUT, PLAIN, HEXAGON MS356 50-302 (96906)	EA	2	REF	REF	REF	REF	REF	REF	REF	REF	13	26
1----		ROD ASSEMBLY, PUSH 21-004-002 (82807)		1									13	27
P-F--	5310-476-7504	NUT, PLAIN, HEXAGON 11-210-011 (82807)	EA	2	*	*	*	*	*	*	1	1	13	28
P-F--	5970-432-7438	TUBE, MICA HIGH TEMPERATURE 31-053-005 (82807)	EA	2	2	3	6	2	3	6	75	100	13	29
P2F--	5310-472-8910	WASHER, NONMETALLIC 12-800 -011 (82807)	EA	4	*	*	*	*	*	*	5	10	13	30
1----		BUSHING, ROD ASSEMBLY RHEOSTAT 21-003 (82807)		1									13	31
P-F--	5310-472-9013	WASHER, FLAT 11-217-005 (82807)	EA	2	*	*	*	*	*	*	1	1	13	32
P-F--	5305-716-6301	SCREW, MACHINE, FACE PLATE 11-200-187 (82807)	EA	2	*	*	*	*	*	*	1	1	13	33
P-F--	5305-582-5807	SCREW, MACHINE MS35265-28 (96906)	EA	5	REF	REF	REF	REF	REF	REF	REF	REF	13	34
P-F--	5930-112-0140	SWITCH 21-921 (82807)	EA	1	*	*	1	*	*	1	10	20	13	35
P-F--		SCREW MACHINE MS35265-34 (96906)	EA	2	REF	REF	REF	REF	REF	REF	REF	REF	13	36
2-F--		PIN, TENSION 11-224-055 (82807)	EA	5									13	37
1----		LINKAGE ASSEMBLY 21-934 (82807)		1									13	38
2-F--		LINK, PEDAL CONNECTING 21-9 08-003 (82807)	EA	2									13	39
2-F--		ELBOW 21-922 (82807)	EA	1									13	40
2-F--		LINK, PLUNGER CONNECTING 21-90 8-004 (82807)	EA	2									13	41
P-F--		SCREW MS35265-36 (96906)	EA	1	REF	REF	REF	REF	REF	REF	REF	REF	13	42
1----		COVER, CASE 21-918 (82807)		1									13	43
P-F--		NUT, PLAIN, HEXAGON MS35681-9 (96906)	EA	2	REF	REF	REF	REF	REF	REF	REF	REF	13	44
P-F--	5306-637-9674	SCREW, CAP, HEXAGON HEAD MS35307-336 (96906)	EA	1	*	*	*	*	*	*	1	1	13	45
P2F--		CABLE SET 21-925 (82807)	EA	1	*	*	1	*	*	1	5	10	13	46
2-F--		PLUG 2436 (77881)	EA	1									13	47
P2F--	6150-440-9937	CABLE ES202 (82807)	EA	1	*	*	*	*	*	*	5	10	13	48
2-F--		TERMINAL, QUICK DISCONNECT 11-301-002 (82807)	EA	2									13	49
2-F--		TERMINAL, LUG 11-300-027 (82807)	EA	2									13	50
P2F--	5975-432-7506	CLAMP, CABLE 21-933 (82807)	EA	1	*	*	*	*	*	*	5	10	13	51

SECTION II, REPAIR PARTS FOR DIRECT SUPPORT, GENERAL SUPPORT, AND DEPOT MAINTENANCE (CONTINUED)

(1) SMR CODE	(2) FEDERAL STOCK NUMBER	DESCRIPTION REFERENCE NUMBER & MFR. CODE	(4) UNIT OF MEAS	(5) QTY NC II UNIT	(6)			30- GS OWAN (a) -20	GS OWAN (b) -5	NT (c) -10	(8) I YR LWPEI EQUIP NTGC	(9) EPOT AJNT WPER 100 DUIP	LLU (a) FIG NO.	(10) RATIONS (b) ITEM NO.
					30- Y DS LOWAN (a) -20	INT (b) -50	INT (c) -10							
P-F--	310-476-7582	NUT, PLAIN, HEXAGON 11-211-003 (82807)	EA	1	*	*	*	*	*	*	1	1	13	52
1----		FOOT, RUBBER 253W (82807)		4									13	53
1----		BASE 21-917 (82807)		1									13	54
P-0--	305-757-8122	SCREW, TAPPING THREAD FORMING MS51851-64 (96906)	EA	4	*	*	*	*	*	*	1	1	13	55
P-0--	310-809-4058	WASHER, FLAT MS27183-10 (96906)	EA	4	EF	EF	EF	EF	EF	EF	EF	REF	13	56
GROUP 07-ACCESSORIES														
P-0--		TRAINER 400-0001-114 (90800)	EA	1									14	1
P-0--	730-222-1837	IPPLE 326X4 (79470)	EA	1									14	2
P-0--		IMER, SEQUENTIAL HB38-31005 (77342)	EA	1	EF	EF	EF	EF	EF	EF	EF	REF	14	3
P-0--		IMER, SEQUENTIAL KB38-31002 (77342)	EA	1	*	1	2	*	1	2	20	40	14	4
P20--	50-451-3013	ABLE ASSEMBLY, ELECTRODE 9G2060 (96073)	EA	1	*	*	*	*	*	*	5	10	14	5
1----		CABLE, ELECTRICAL 29 R691-50 (96073)		1									14	6
1----	40-507-6837	TERMINAL, LUG R2012 (26132)		1									14	7
		HOLDER, ELECTRODE, WELDING AF3 (30733)		1									14	8
P20	150-451-3014	ABLE ASSEMBLY, GROUND 9G2061 (96073)	EA	1	*	*	*	*	*	*	5	10	14	9
----		CLAMP, GROUND HIAMP300 (30733)		1									14	10
1---		CABLE, ELECTRICAL 29 R691-50 (96073)		1									14	11
1---	40-507-6837	TERMINAL, LUG R2012 (26132)		1									14	12

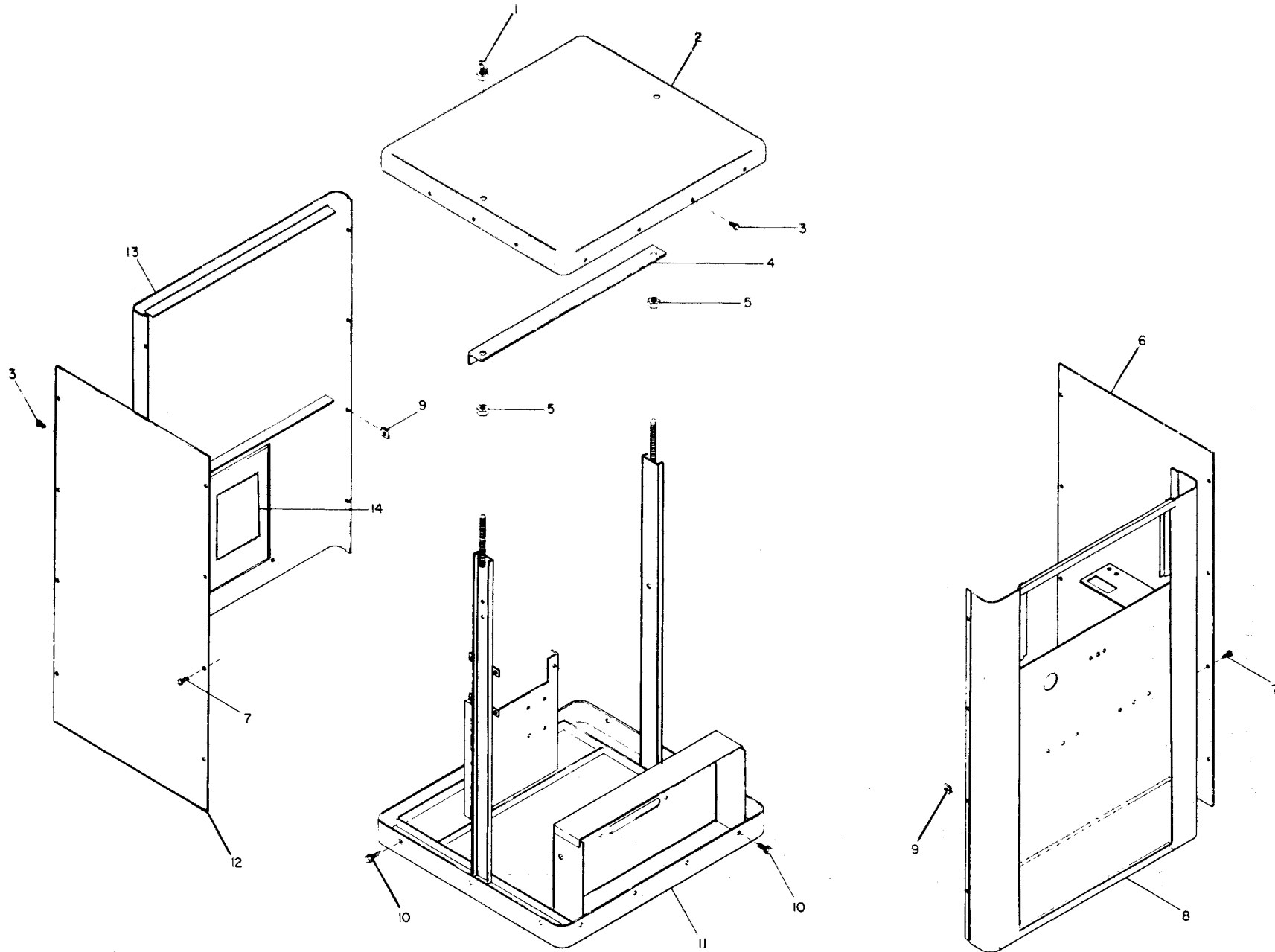
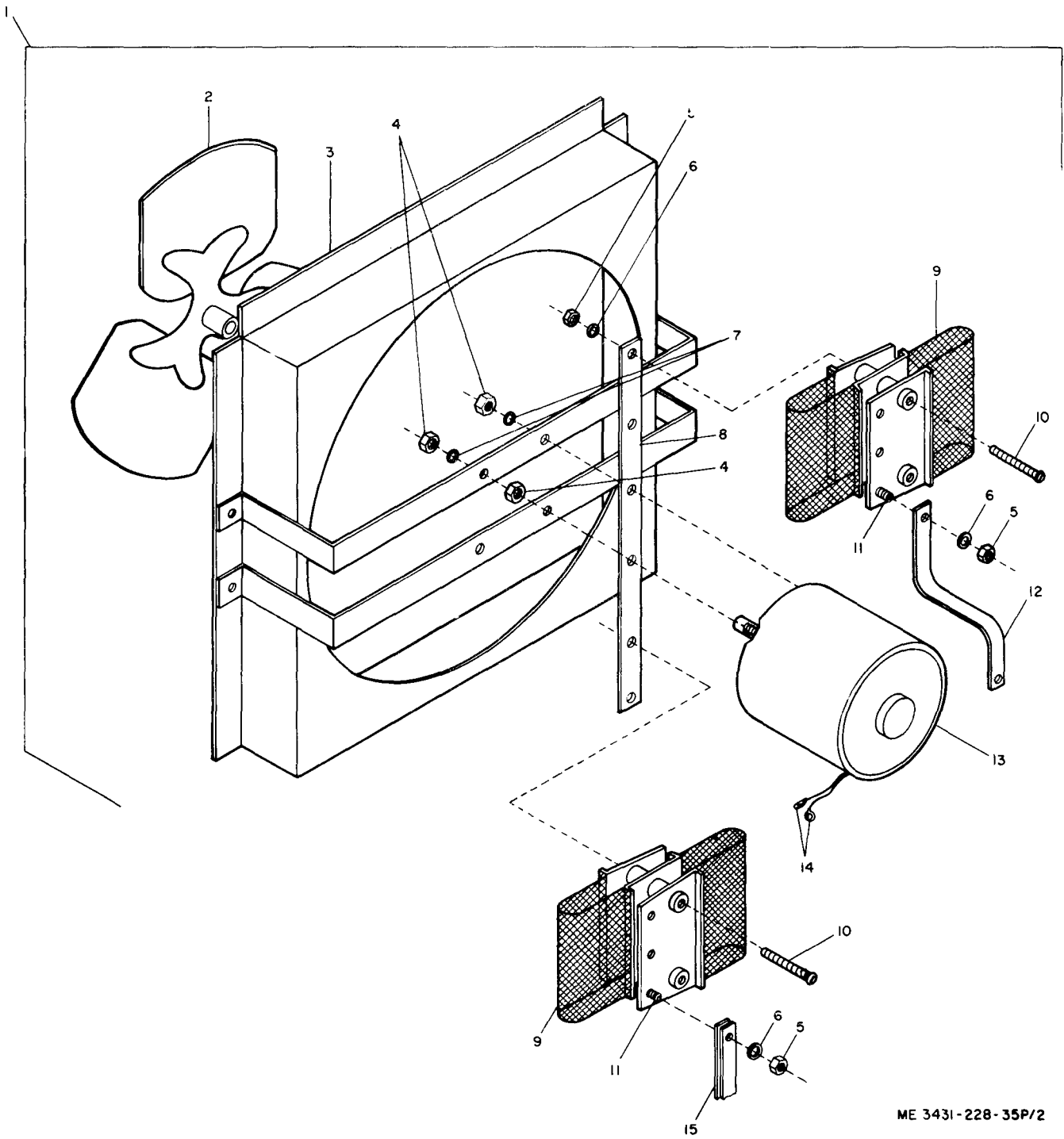

Figure 1. Frame and cabinet.

ME 3431-228-35P/1



ME 3431-228-35P/2

Figure 2. Fan and motor

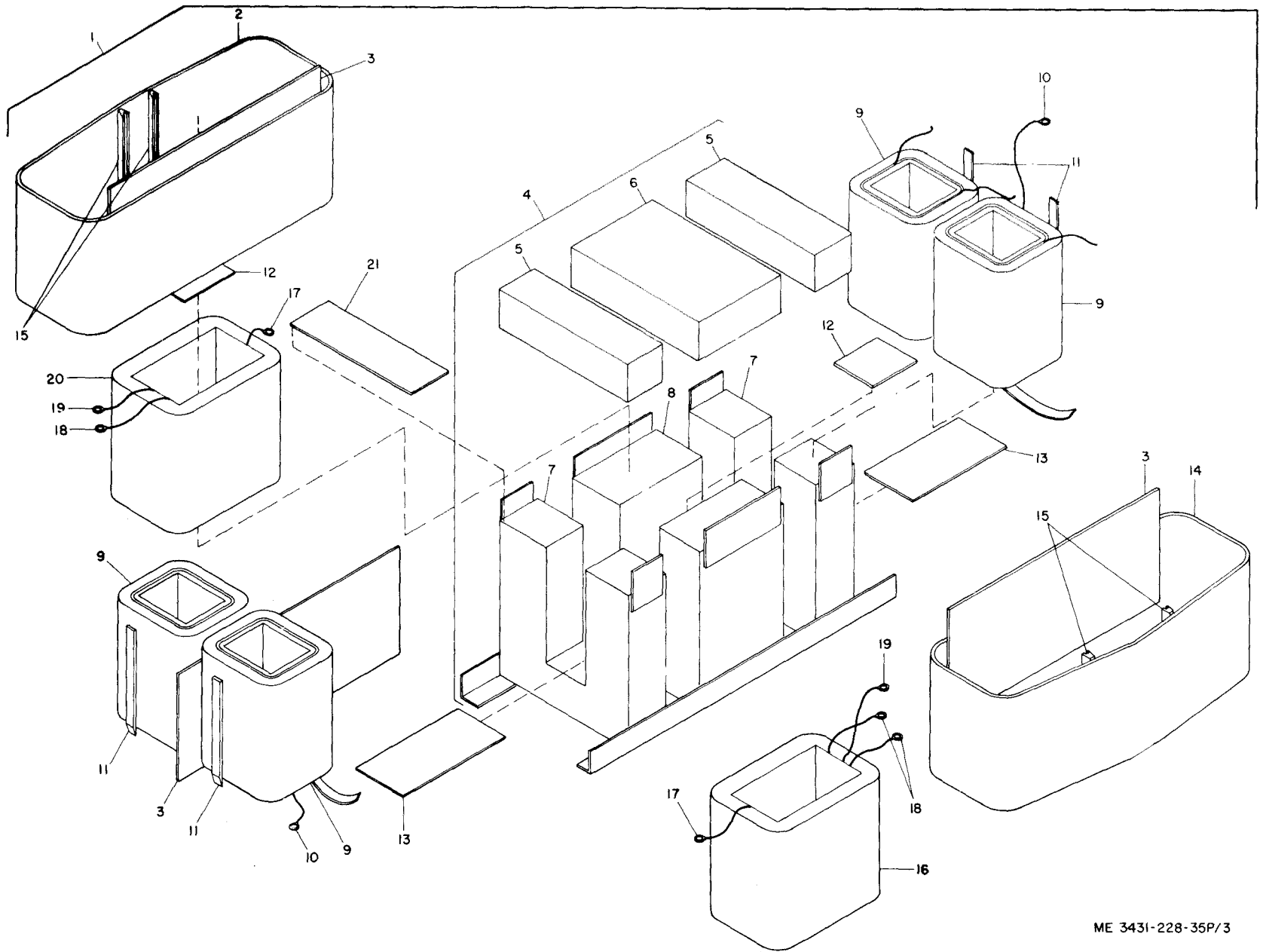

ME 3431-228-35P/3

Figure 3. Transformer.

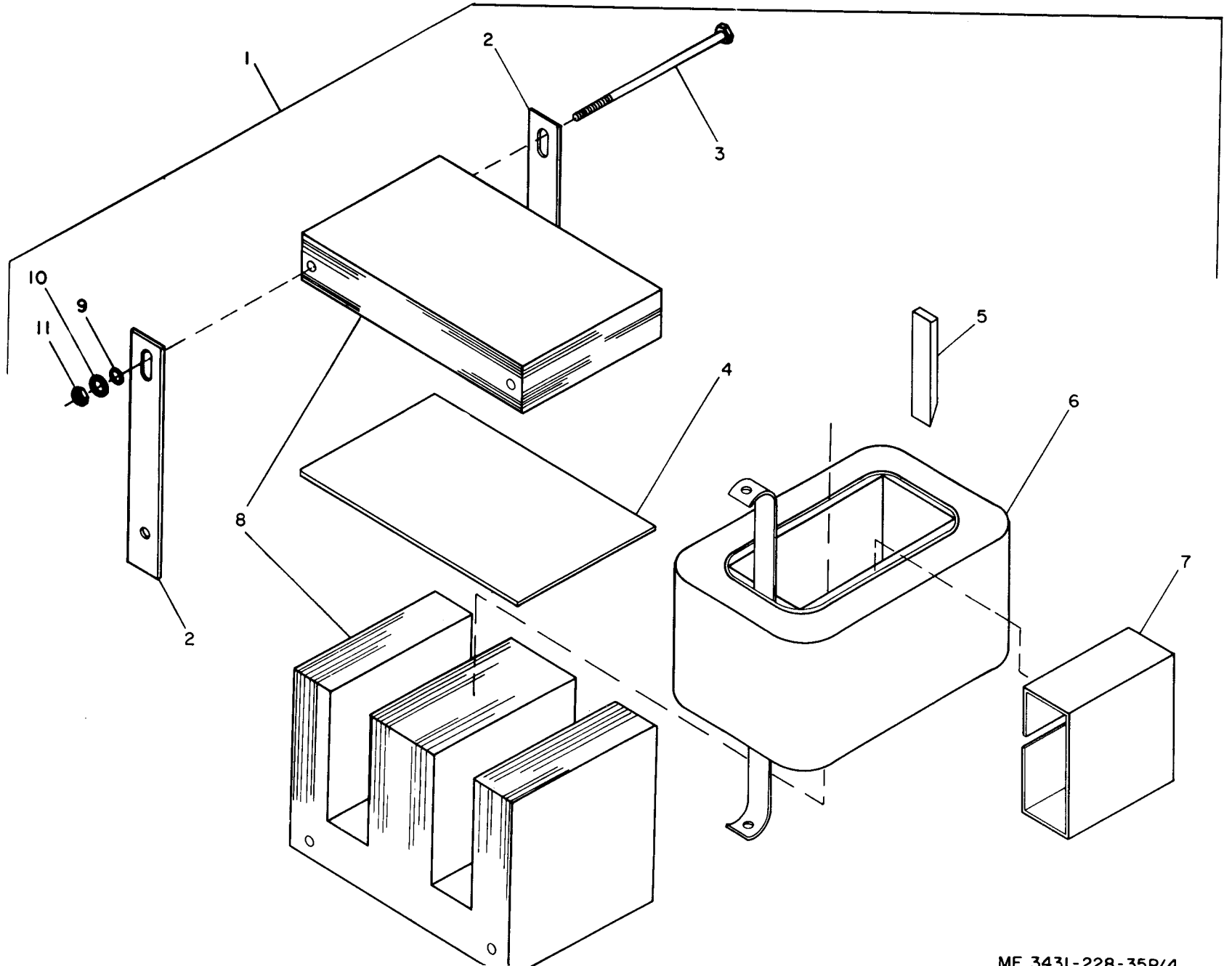

Figure 4. Reactor filter.

ME 3431-228-35P/4

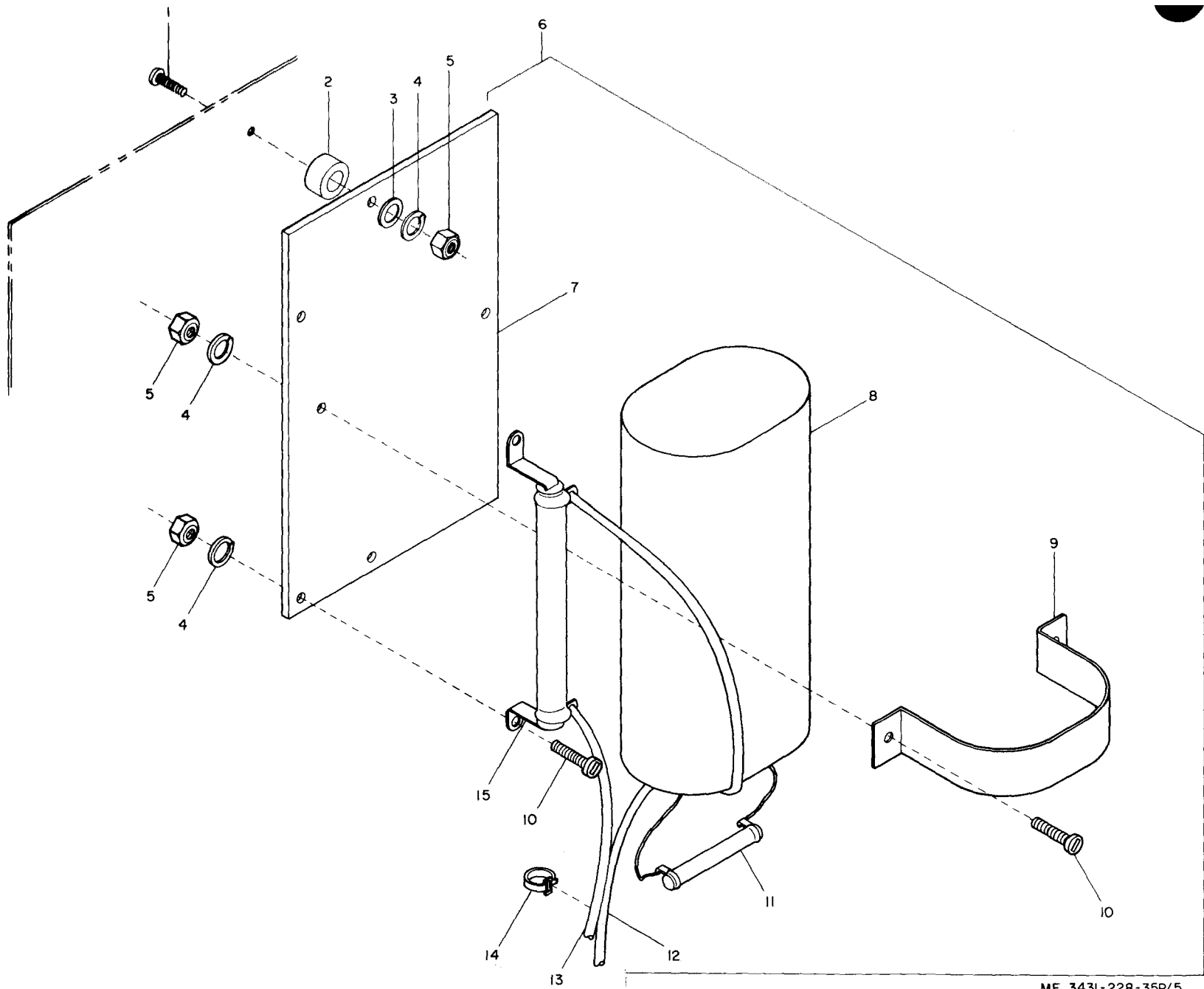

Figure 5. Stabilizer.

ME 3431-228-35P/5

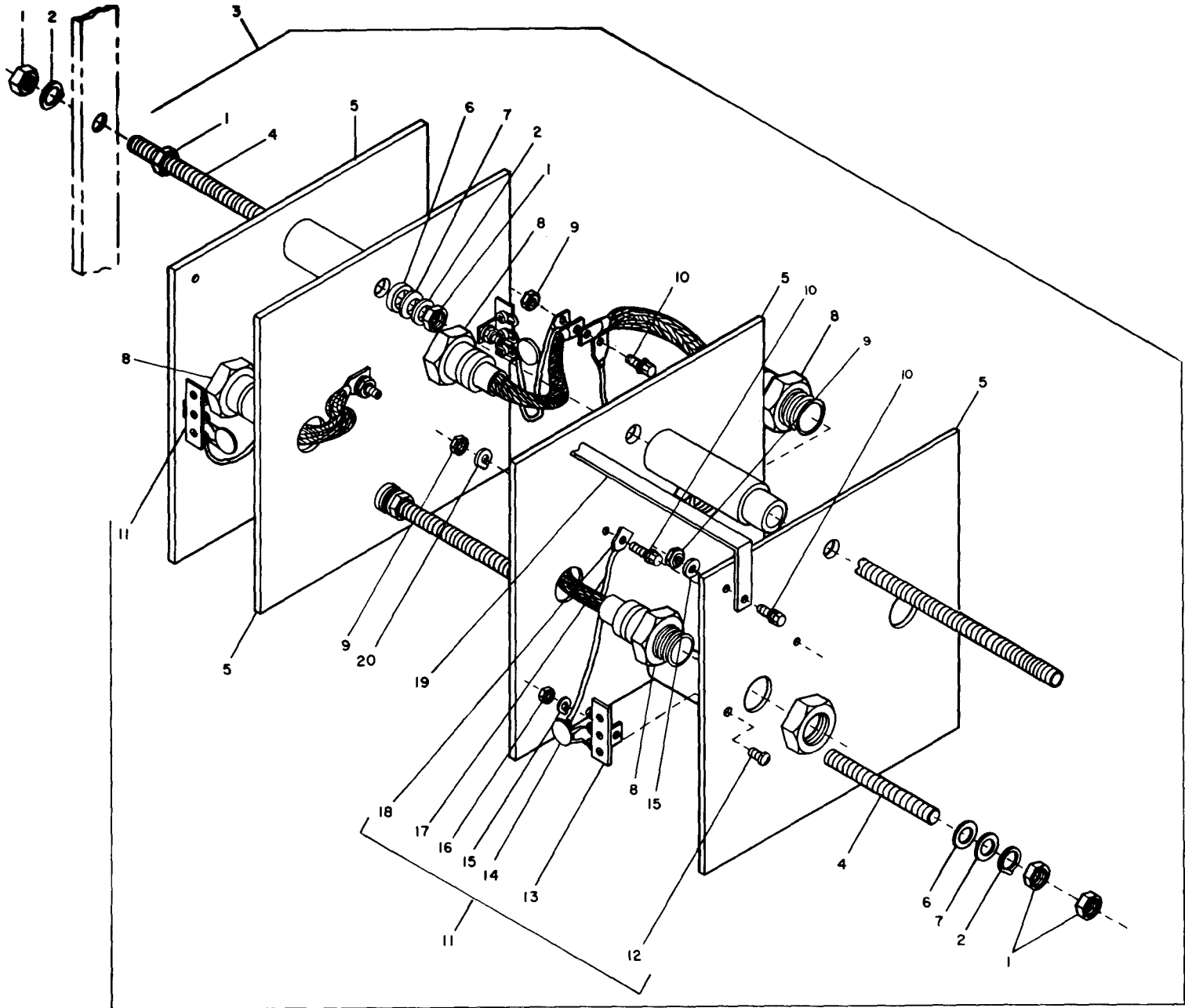

Figure 6. Rectifier assembly.

ME 3431-228-35P/6

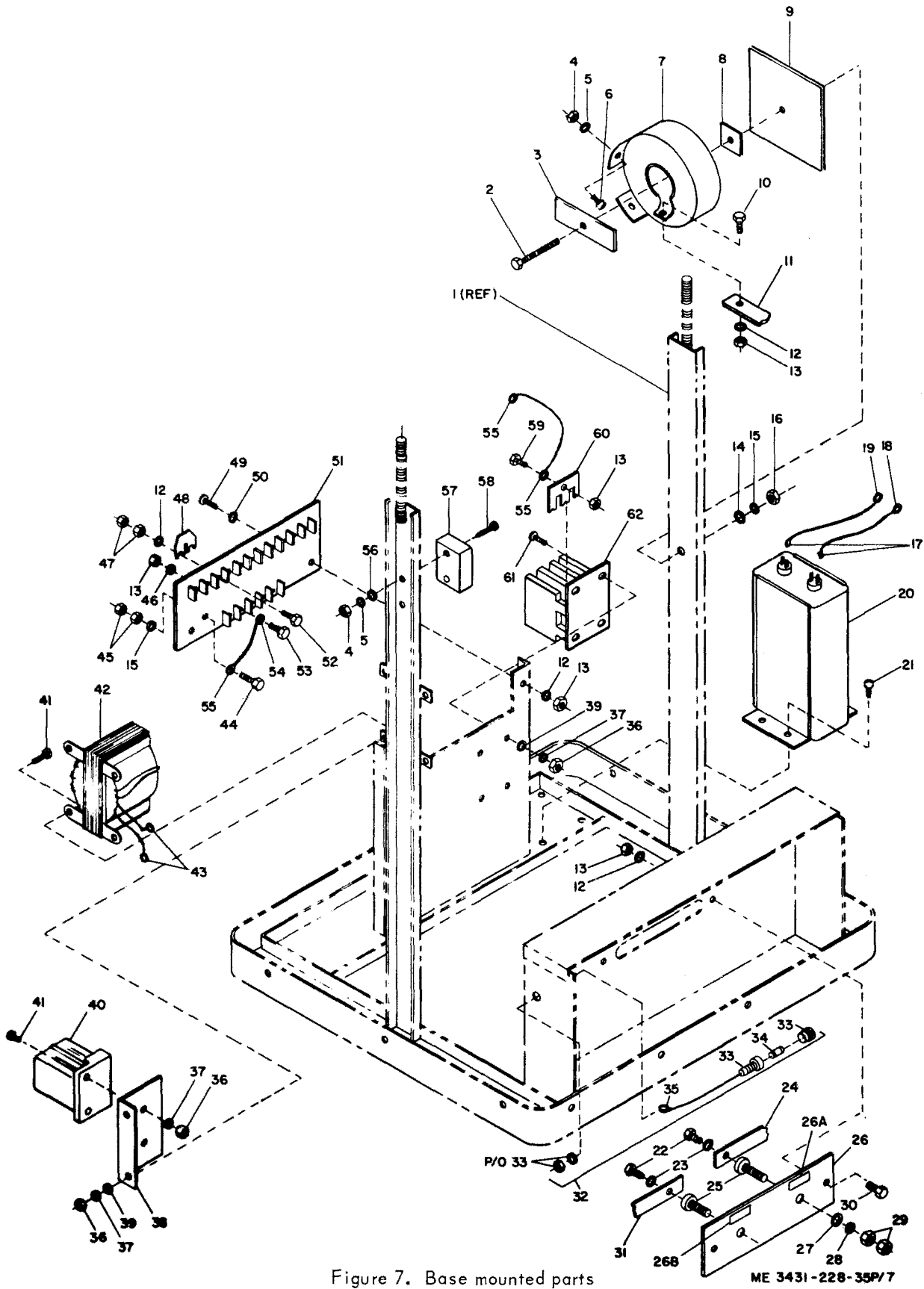
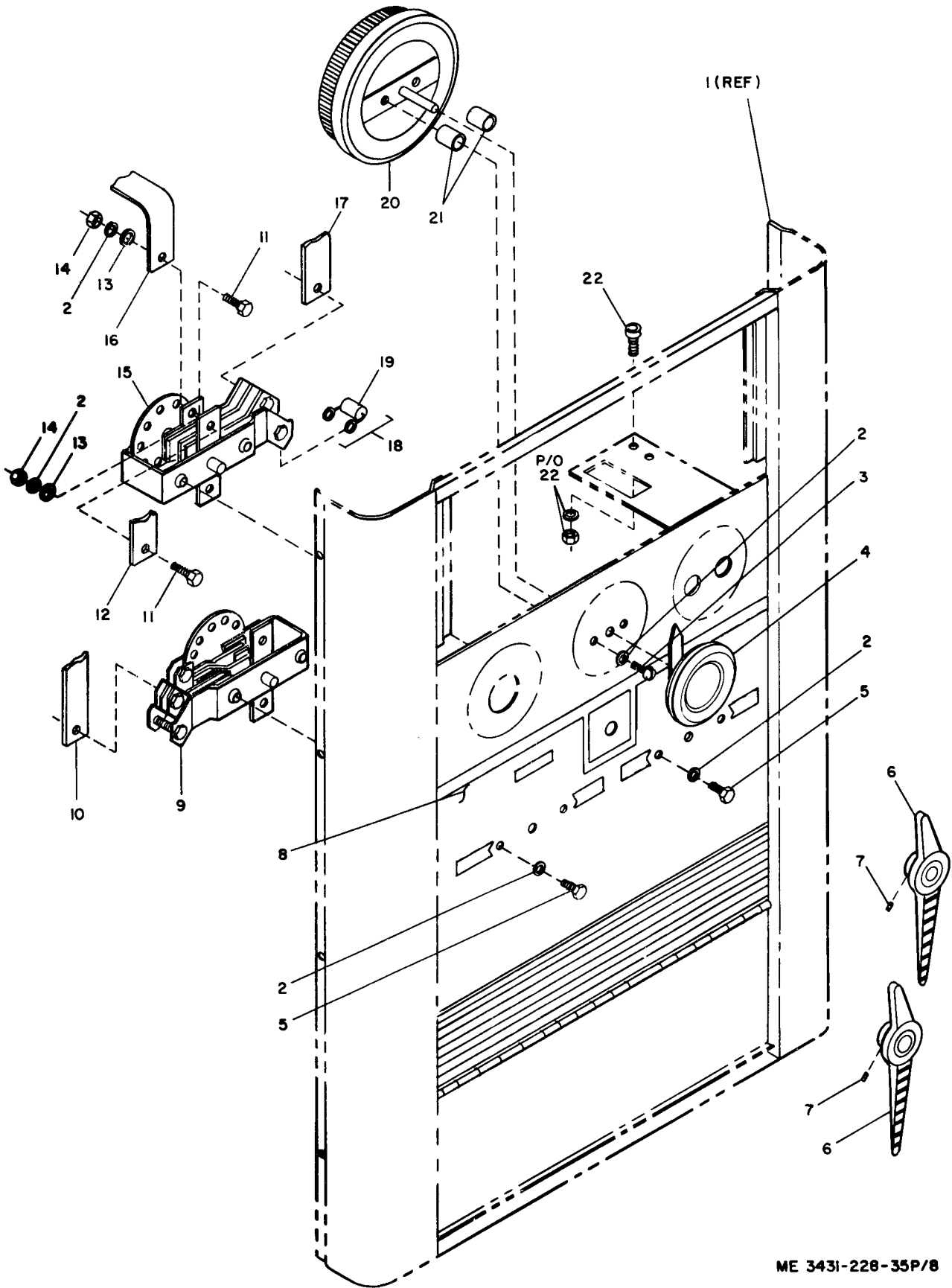

Figure 7. Base mounted parts

ME 3431-228-35P/7



ME 3431-228-35P/8

Figure 8. Front panel.

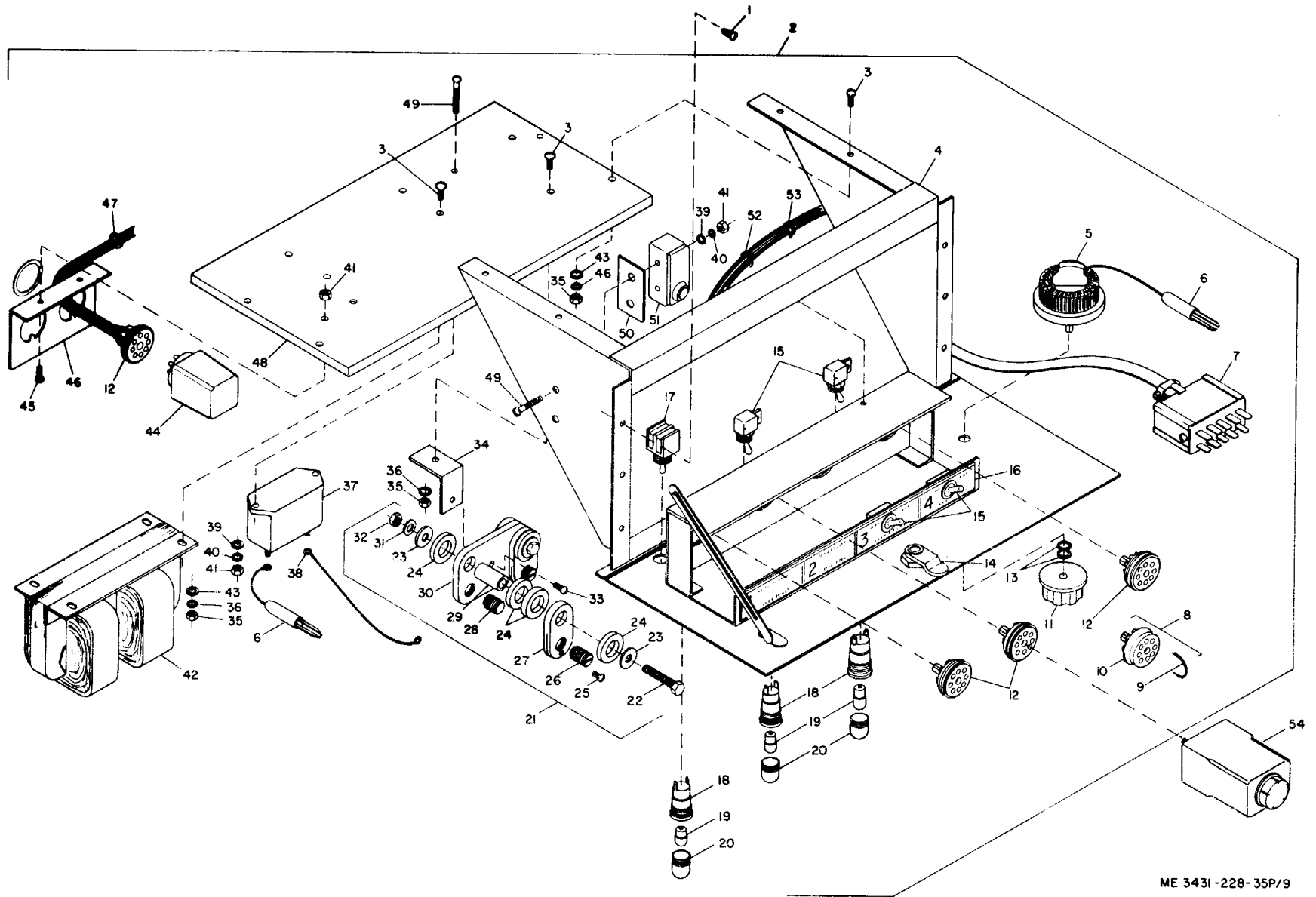

ME 3431 -228- 35P/9

Figure 9. High frequency drawer.

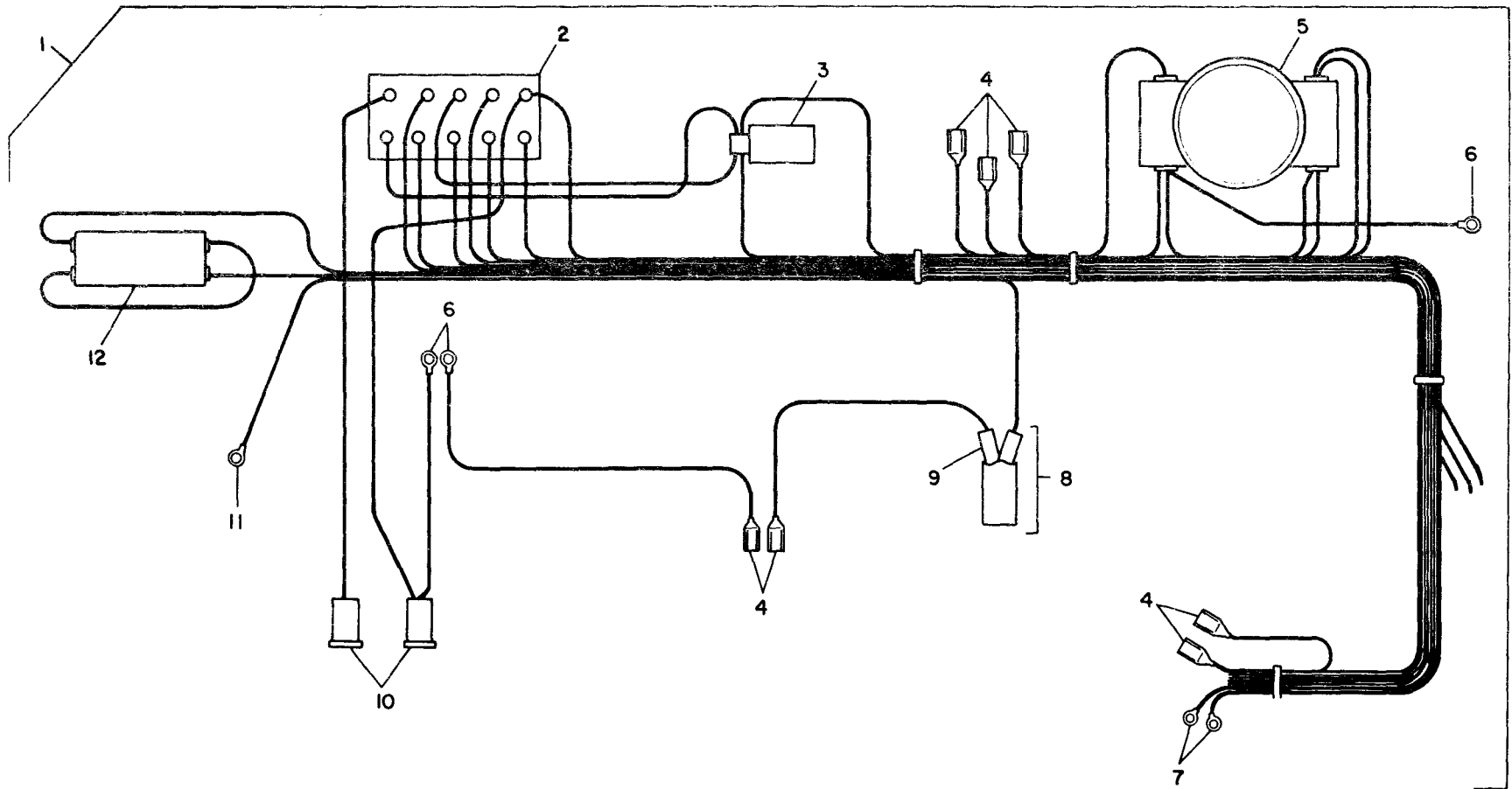

ME 3431-228-35P/10

Figure 10. Wiring harness.

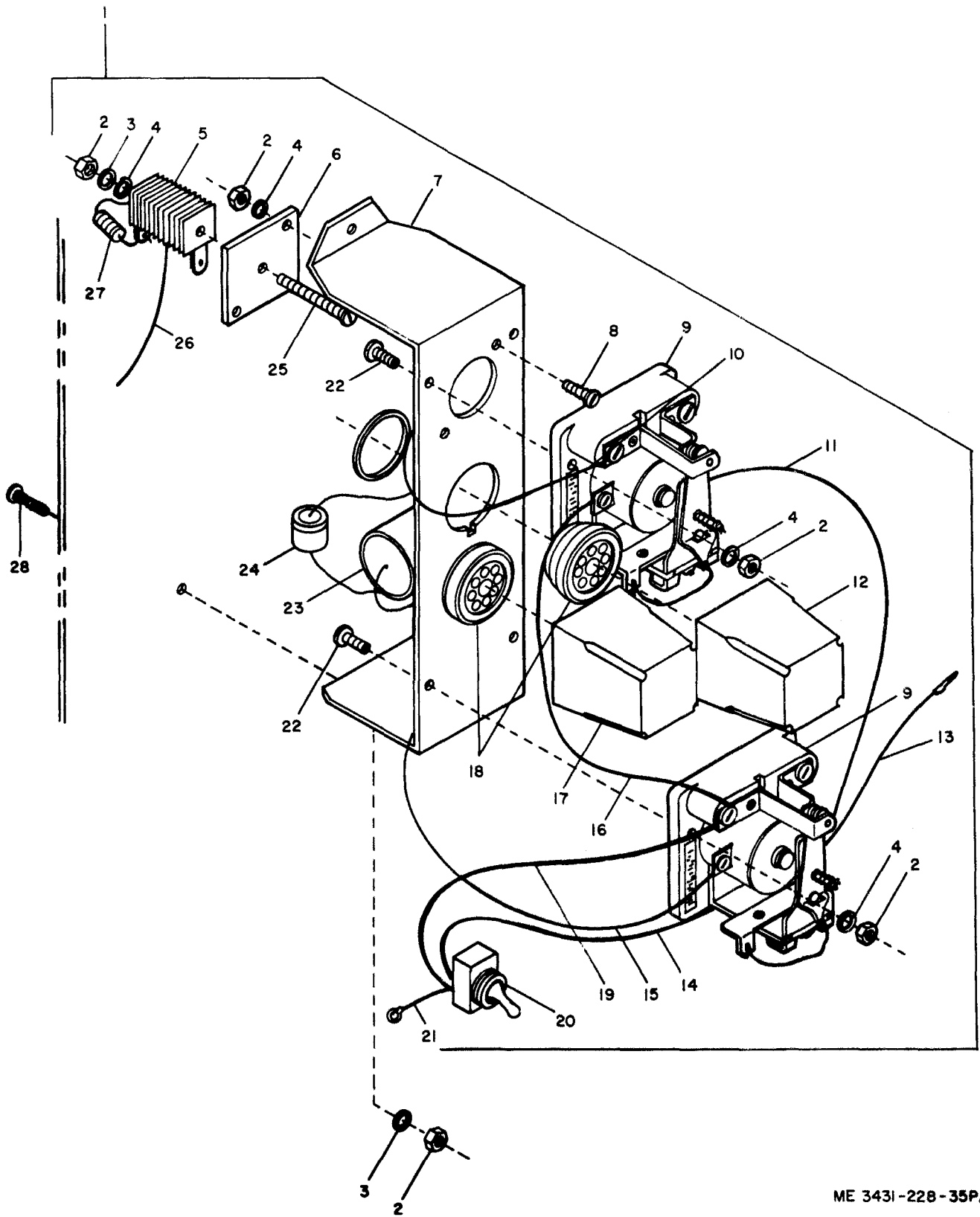

ME 3431-228-35P/11

Figure 11. Pilot rectifier and relay assembly.

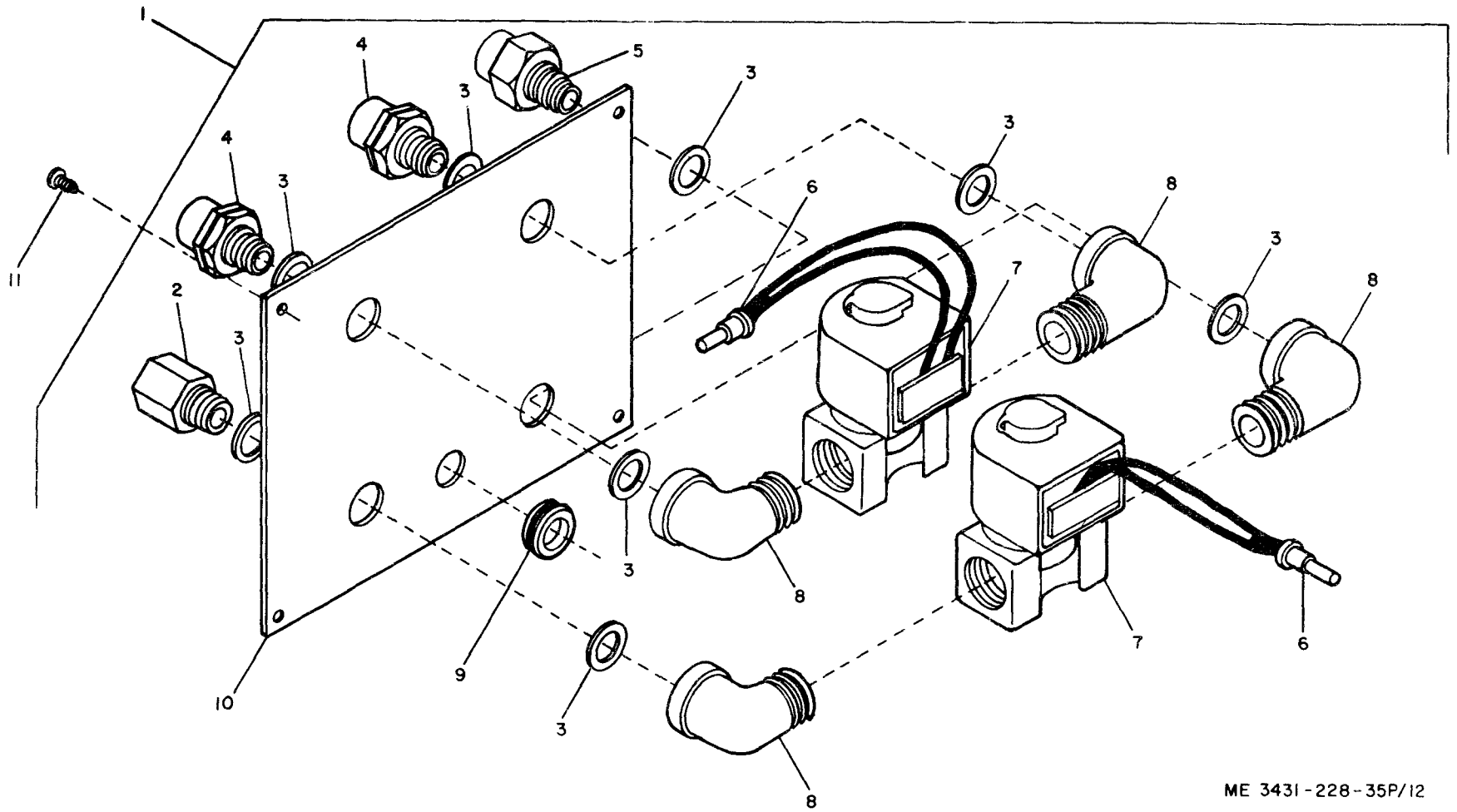

ME 3431-228-35P/12

Figure 12. Gas and water valve assembly.

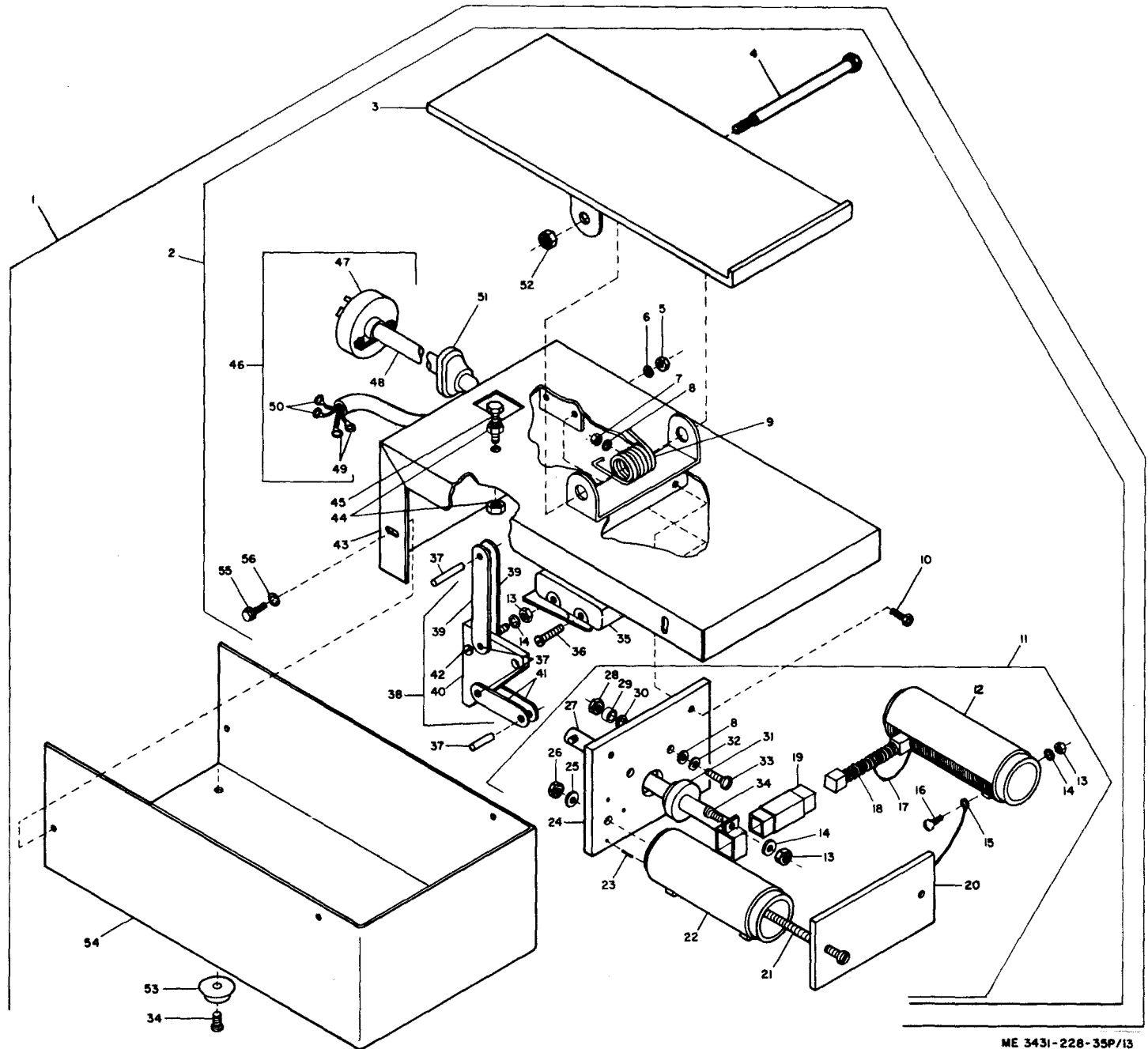
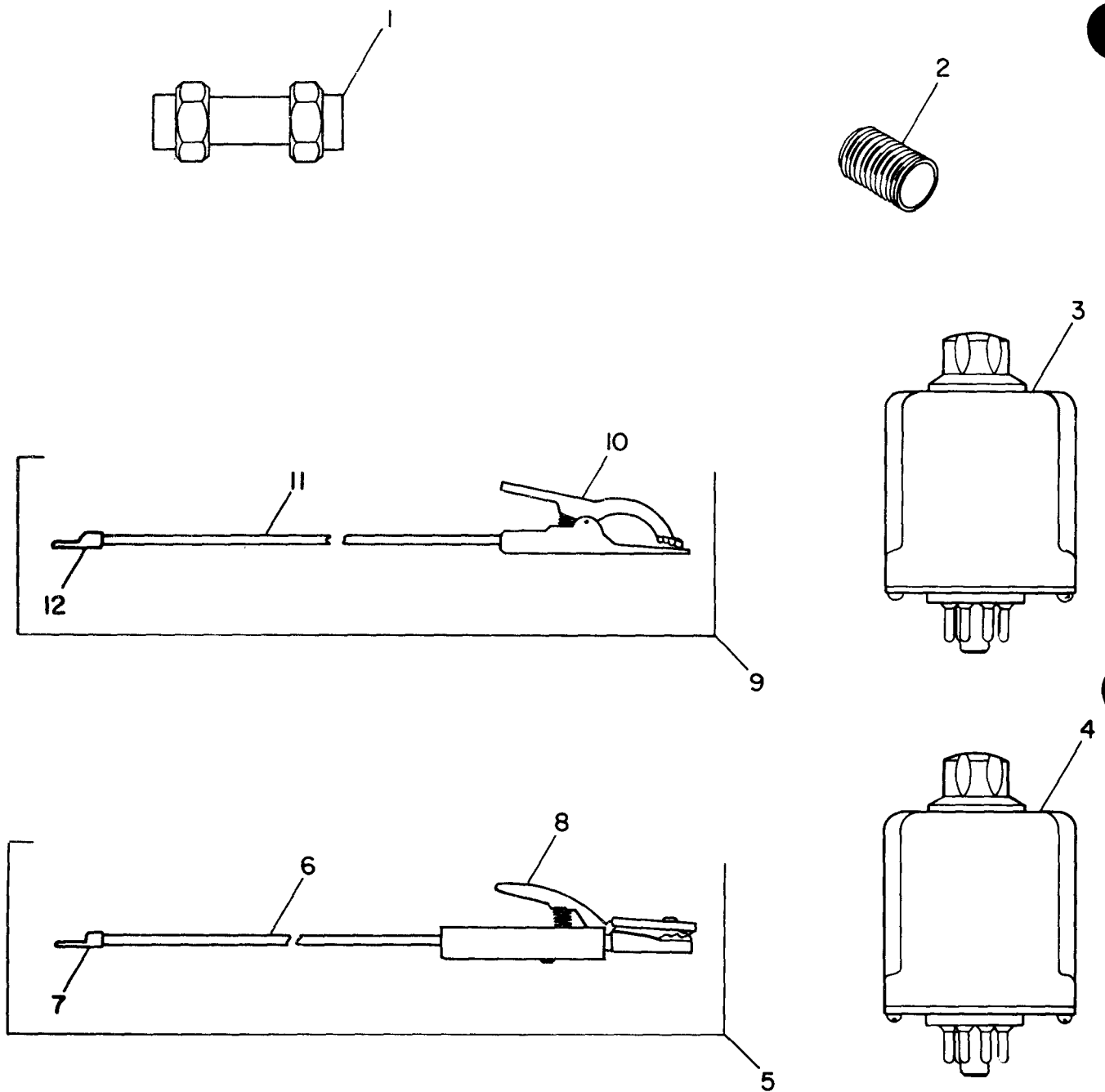

Figure 13. Foot control.

ME 3431-228-35P/13



ME 3431-228-35P/14

Figure 14. Accessories

Section IV. **INDEX STOCK NUMBER AND REFERENCE NUMBER
CROSS-REFERENCE TO FIGURE AND ITEM NUMBER**

<u>Stock Number</u>	<u>Figure No.</u>	<u>Item No.</u>	<u>Stock Number</u>	<u>Figure No.</u>	<u>Item No.</u>
2920-217-9118	7	33	5305-582-5807	13	34
3431-083-2655	7	42	5305-582-5808	9	45
3431-134-8104	9	21	5305-582-5808	11	22
3431-451-0999	5	6	5305-614-0267	9	49
3431-451-1000	9	27	5305-622-9474	7	58
3431-451-1001	9	4	5305-622-9483	2	10
3431-451-6010	9	30	5305-660-2625	7	41
3431-451-6011	10	1	5305-716-6288	4	3
4140-738-9881	2	2	5305-716-6289	13	16
4730-222-1837	14	2	5305-716-6308	13	33
4730-301-7470	12	2	5305-716-6312	9	26
4730-932-1010	12	4	5305-716-6313	9	28
5305-021-3616	2	11	5305-716-6316	1	10
5305-021-3616	6	10	5305-717-5467	7	53
5305-021-3616	7	30	5305-719-3997	7	10
5305-080-7336	7	49	5305-719-3997	8	5
5305-080-7336	8	3	5305-757-8122	13	55
5305-207-2297	9	22	5305-757-8287	1	3
5305-514-7506	11	8	5305-757-8287	7	21
5305-543-5198	5	1	5305-757-8292	1	7
5305-543-5198	11	25	5305-934-9751	2	4
5305-543-5828	7	59	5305-940-9426	7	22
5305-550-3934	7	52	5305-954-8157	13	21
5305-579-2139	7	61	5306-011-6549	7	44
5305-582-5807	5	10	5306-637-9674	13	45
5305-582-5807	6	12	5306-958-1148	7	2
5305-582-5807	9	1	5307-472-9886	7	25
5305-582-5807	9	25	5310-013-4530	9	41
5305-582-5807	11	28	5310-045-3296	2	7
5305-582-5807	7	6	5310-045-3296	7	37

Section IV. **INDEX - FEDERAL STOCK NUMBER AND REFERENCE NUMBER**
CROSS-REFERENCE TO FIGURE AND ITEM NUMBER (CONT.)

<u>Stock Number</u>	<u>Figure No.</u>	<u>Item No.</u>	<u>Stock Number</u>	<u>Figure No.</u>	<u>Item No.</u>
5310-045-4007	5	4	5310-757-6524	1	9
5310-045-4007	6	15	5310-809-3078	4	10
5310-045-4007	7	4	5310-809-3078	9	23
5310-045-4007	11	4	5310-809-4058	7	50
5310-082-1404	5	3	5310-809-4058	13	56
5310-082-1404	7	56	5310-809-4061	6	7
5310-082-1404	9	39	5310-809-4061	7	14
5310-082-1404	11	56	5310-809-4061	9	13
5310-087-7493	8	13	5310-809-8544	7	39
5310-088-5285	12	3	5310-809-8544	9	43
5310-186-7454	9	40	5310-834-8732	1	5
5310-407-9566	7	15	5310-851-2674	2	5
5310-472-8910	13	30	5310-851-2674	4	11
5310-472-9013	13	32	5310-851-2674	6	9
5310-476-7521	13	25	5310-851-2674	7	13
5310-476-7522	13	14	5310-851-2674	8	14
5310-476-7582	13	52	5310-851-2674	9	32
5310-476-7584	13	28	5310-851-2682	6	1
5310-476-7587	13	13	5310-889-2528	7	46
5310-477-0332	6	6	5310-891-1709		16
5310-477-0333	9	24	5310-903-3996	7	45
5310-582-5965	2	6	5310-913-5472		30
5310-582-5965	6	20	5310-924-4218	7	47
5310-582-5965	7	12	5310-934-9747	5	5
5310-582-5965	8	2	5310-934-9747	6	16
5310-582-8965	4	9	5310-934-9747	7	4
5310-584-5272	7	28	5310-934-9747	11	2
5310-637-9541	6	2	5310-934-9757	7	36
5310-637-9541	7	23	5325-290-4344	12	9
5310-724-4218	7	47	5340-782-8737	5	14

IV. INDEX - FEDERAL STOCK NUMBER AND REFERENCE NUMBER CROSS-REFERENCE TO FIGURE AND ITEM NUMBER (CONT)

<u>Stock Number</u>	<u>Figure No.</u>	<u>Item No.</u>	<u>Stock Number</u>	<u>Figure No.</u>	<u>Item No.</u>
5355-613-9740	8	4	5940-113-9825	7	55
5360-472-7983	13	9	5940-114-1306	7	54
5365-477-0309	8	21	5940-115-0774	3	17
5905-100-4611	5	15	5940-115-4991	3	18
5905-472-3577	2	9	5940-143-4780	9	38
5905-549-5335	5	11	5940-143-4780	10	7
5905-755-2432	9	5	5940-156-7135	2	14
5910-079-3761	11	23	5940-156-7135	6	18
5910-452-0948	8	18	5940-199-5949	10	7
5910-455-0851	7	20	5940-236-0515	7	43
5910-472-3582	2	19	5940-245-5949	10	6
5910-472-3582	6	11	5940-432-7437	7	48
5910-577-1138	6	14	5940-507-6837	14	7
5910-985-0457	8	19	5940-874-1006	3	19
5920-280-9539	7	34	5945-259-5579	11	1
5930-119-0142	13	35	5945-452-0944	9	54
5930-410-6136	10	3	5945-472-3551	9	44
5930-472-3578	10	8	5945-472-3558	11	12
5930-543-0839	9	51	5950-472-3562	9	42
5930-646-4360	9	17	5950-472-3579	7	7
5930-655-1515	11	20	5950-472-3580	4	1
5930-797-3732	9	15	5950-472-3587	3	1
5935-171-3001	12	6	5961-417-7096	11	24
5935-222-9932	9	12	5970-432-7438	13	29
5935-222-9932	11	18	5975-074-2072	9	52
5935-257-6397	10	5	5975-432-7506	13	51
5935-303-0691	9	10	5977-451-8375	13	18
5935-452-0951	9	8	6110-451-1241	7	26
5935-581-1073	10	10	6130-451-1642	6	3
5940-113-9825	3	10	6130-451-6141	7	57

Section IV. INDEX --- FEDERAL STOCK NUMBER AND REFERENCE NUMBER
CROSS-REFERENCE TO FIGURE AND ITEM NUMBER (CON'T)

<u>Stock Number</u>	<u>Figure No.</u>	<u>Item No.</u>	<u>Stock Number</u>	<u>Figure No.</u>	<u>Item No.</u>
6130-557-7153	11	5	6150-451-8388	7	35
6150-449-9937	13	48	6150-451-8392	11	21
6150-451-1239	6	19	6150-451-8393	11	13
6150-451-1240	7	60	6150-469-2336	11	11
6150-451-3010	2	15	6150-469-2337	5	13
6150-451-3014	14	9	6150-469-2338	11	16
6150-451-3113	14	5	6150-469-2340	11	15
6150-451-8385	11	14	6150-469-2342	11	10
6150-451-8386	5	12	6150-469-2350	11	26
6150-451-8387	11	19	6210-469-6714	9	18
			6240-682-3411	9	19

<u>Reference No.</u>	<u>Mfg Code</u>	<u>Fig. No.</u>	<u>Item No.</u>	<u>Reference No.</u>	<u>Mfg Code</u>	<u>Fig. No.</u>	<u>Item No.</u>
ACC330U9	04009	7	62	ES202	82807	13	48
AF3	30733	14	8	E1225SH	34353	4	8
AH20994LG	04009	9	15	HCC1-617XXA	74193	7	40
AH20994LG	04009	10	3	HKP	71400	7	33
AN502-10-12	88044	9	33	HP4N	09922	5	14
AW15	16166	12	5	H1AMP300	30733	14	10
BR500-50	09023	11	23	KCP112500-2	77342	11	17
B14-13S441	96073	11	19	KN110-2C24A	22039	9	44
B18-11S475	96073	11	26	KN1152C10KS	22039	11	12
B18-3S2210	96073	11	15	KTL16U306Q	09023	5	8
B18-4	96073	6	17	MS27183-10	96906	7	50
B18-6-2210-2210	96073	11	16	MS27183-10	96906	13	56
CB2J016-230V	62119	2	13	MS27183-11	96906	4	10
CHB38-31005	77342	9	54	MS27183-11	96906	9	23
CHB38-31005	77342	14	3	MS27183-13	96906	8	13
CKB38-31002	77342	14	4	MS27183-15	96906	6	7
C185A	71747	1	1	MS27183-15	96906	7	14
C60387AD10-824	78553	9	53	MS27183-15	96906	9	13
C60387AD4-824	78553	9	47	MS27183-20	96906	12	3
C8109-8-4	78553	1	9	MS27183-6	96906	5	3
D279S5330	58849	6	8	MS27183-6	96906	7	56
D3575F	81483	11	5	MS27183-6	96906	9	39
D5425C-S	74842	9	14	MS27183-6	96906	11	3
EHS3B1	58849	7	57	MS27183-7	96906	7	39
				MS27183-7	96906	9	43

Section IV. INDEX - FEDERAL STOCK NUMBER AND REFERENCE NUMBER
CROSS-REFERENCE TO FIGURE AND ITEM NUMBER (Cont)

<u>Reference No.</u>	<u>Mfg Code</u>	<u>Fig. No.</u>	<u>Item No.</u>	<u>Reference No.</u>	<u>Mfg. Code</u>	<u>Fig. No.</u>	<u>Item No.</u>
MS35215-65	96906	13	21	MS35309-357	96906	7	22
MS35265-26	96906	11	8	MS35309-8	96906	7	52
MS35265-28	96906	5	10	MS35338-41		5	4
MS35265-28	96906	6	12	MS35338-41	96906	6	15
MS35265-28	96906	9	11	MS35338-41	96906	7	5
MS35265-28	96906	9	25	MS35338-41	96906	9	40
MS35265-28	96906	11	28	MS35338-41	96906	11	4
MS35265-28	96906	13	34	MS35338-41	96906	13	6
MS35265-30	96906	7	61	MS35338-43	96906	2	7
MS35265-31	96906	7	6	MS35338-43	96906	7	37
MS35265-31	96906	9	45	MS35338-43	96906	9	36
MS35265-31	96906	11	22	MS35338-44	96906	2	6
MS35265-34	96906	9	49	MS35338-44	96906	4	9
MS35265-34	96906	13	36	MS35338-44	96906	6	20
MS35265-35	96906	7	58	MS35338-44	96906	7	12
MS35265-36	96906	5	1	MS35338-44	96906	8	2
MS35265-36	96906	11	25	MS35338-44	96906	9	31
MS35265-36	96906	13	42	MS35338-44	96906	13	8
MS35265-47	96906	7	41	MS35338-45	96906	7	15
MS35265-47	96906	9	3	MS35338-46	96906	6	2
MS35265-81	96906	2	10	MS35338-46	96906	7	23
MS35265-86	96906	7	49	MS35338-48	96906	7	28
MS35265-86	96906	8	3	MS35649-62	96906	5	5
MS35307	96906	4	3	MS35649-62	96906	6	16
MS35307-303	96906	7	10	MS35649-62	96906	7	4
MS35307-303	96906	8	5	MS35649-62	96906	9	41
MS35307-305	96906	2	11	MS35649-62	96906	11	2
MS35307-305	96906	6	10	MS35649-62	96906	13	5
MS35307-305	96906	7	30	MS35649-82	96906	7	36
MS35307-312	96906	9	22	MS35649-82	96906	9	35
MS35307-336	96906	13	45	MS35650-302	96906	2	4
MS35307-348	96906	7	2	MS35650-302	96906	13	26
MS35307-362	96906	7	53	MS35691-1	96906	2	5
MS35307-376	96906	13	4	MS35691-1	96906	4	11
MS35309-306	96906	7	59	MS35691-1	96906	6	9
MS35309-306	96906	8	11	MS35691-1	96906	7	13
MS35309-306	96906	13	10	MS35691-1	96906	8	14
MS35309-34	96906	7	44	MS35691-1	96906	9	32

Section IV. INDEX - FEDERAL STOCK NUMBER AND REFERENCE NUMBER
CROSS-REFERENCE TO FIGURE AND ITEM NUMBER (Cont)

<u>Reference No.</u>	<u>Mfg Code</u>	<u>Fig. No.</u>	<u>Item No.</u>	<u>Reference No.</u>	<u>Mfg. Code</u>	<u>Fig. No.</u>	<u>Item No.</u>
MS35691-1	96906	13	7	W14-23S441	96073	11	21
MS35691-17	96906	6	1	W14-25S441	96073	7	35
MS35691-33	96906	1	5	W18	96073	9	9
MS35691-9	96906	7	16	Y22RD	91929	9	51
MS35691-9	96906	13	44	0310	44655	9	5
MS4590-68	96906	7	46	0400C	44655	5	15
MS51851-43	96906	1	3	1-562-125-910	34463	6	6
MS51851-43	96906	7	21	1-562-125-910	34463	7	27
MS51851-43	96906	12	11	1G1989	96073	8	6
MS51851-44	96906	1	7	1N4723	04713	11	24
MS51851-64	96906	13	55	108-0302	74970	9	6
MS51969-2	96906	7	45	108-0902	74970	8	22
MS51970-1	96906	7	47	11-200-057	82807	13	16
MS51970-5	96906	7	29	11-200-187	82807	13	33
NE51H	08805	9	19	11-210-005	82807	13	13
N1420-3	60399	2	2	11-210-011	82807	13	28
N18-11S2210	96073	11	13	11-211-003	82807	13	52
N18-5-2210-2210	96073	11	11	11-214-003	82807	13	14
N44493C	44655	8	20	11-214-005	82807	13	25
PKM16547	09023	8	19	11-217-005	82807	13	32
PR5AY24VSPDT	77342	11	9				
P18-5-1-2S2210	96073	11	10	11-224-055	82807	13	37
R1170S	26132	7	18	11-300-027	82807	13	50
R2012	26132	14	7	11-301-002	82807	13	49
R3458B	26132	7	43	11G1284	96073	5	19
R3461	26132	3	10	11G1587A	96073	6	5
R3461	26132	7	55	11G1705A	93073	7	25
R3462	26132	7	54	11G2200	96073	7	60
R4124B	26132	3	19	11G2209	96073	7	32
R64643	96073	3	18	11G2211	96073	5	6
R8000	96073	3	17	11G2229	96073	7	48
SST2	06383	9	52	11G2241	96073	9	27
S09131	26132	7	17	11G2242	96073	9	30
S09131	26132	10	4	11G2243	96073	9	21
U14-12S475	96073	5	12	11G2250	96073	2	1
U14-13S475	96073	5	13	11R1209	96073	9	26
W14-15S441	96073	11	14	11R139	96073	9	28

Section IV. INDEX - FEDERAL STOCK NUMBER AND REFERENCE NUMBER
CROSS-REFERENCE TO FIGURE AND ITEM NUMBER (Cont)

<u>Reference No.</u>	<u>Mfg Code</u>	<u>Fig. No.</u>	<u>Item No.</u>	<u>Reference No.</u>	<u>Mfg Code</u>	<u>Fig. No.</u>	<u>Item No.</u>
12-800-011	82807	13	30	21-917	82807	13	54
13AT1	91929	9	17	21-918	82807	13	43
13G1817	96073	1	4	21-921	82807	13	35
13G1833	96073	9	34	21-922	82807	13	40
13G1834	96073	4	2	21-925	82807	13	46
13G2189	96073	8	21	21-929	82807	13	9
13G2322	96073	1	11	21-932	82807	13	2
13G2324	96073	11	7	21-933	82807	13	51
13G2405	96073	2	8	21-934	82807	13	38
13G2408	96073	2	3	217GL	09023	9	37
13G2409	96073	9	46	22G1839-1	96073	12	1
13G2410	96073	7	38	22R1759	96073	12	8
13R1142	96073	6	4	24G1596-1	96073	8	15
14R109	96073	7	26B	24G1596-2	96073	8	9
14R2306	96073	9	16	24G2012	96073	10	8
14R2332	96073	1	14	2400-0001-114	90800	14	1
14R2334	96073	8	8	2436	77881	13	47
14R771	96073	7	23A	2475	77881	10	5
15A	16166	12	4	25P52B323	72765	9	20
17G1586	96073	6	3	253W	82807	13	53
1736	44655	5	11	26G2285-2	96073	7	7
18G1854	96073	11	1	26G2286	96073	4	6
19R1785	96073	2	9	26G2324-1	96073	3	16
20-008	82807	13	11	26G2325-1	96073	3	20
20-904	82807	13	1	26G2326	96073	3	14
21-003	82807	13	31	26G2327	96073	3	2
21-004-002	82807	13	27	26G2328	96073	3	9
21-023-001	82807	13	15	264-11-02-030-5A	71785	9	7
21-023-005	82807	13	17	264-12-02-013-1A	71785	10	2
21-035	82807	13	19	27G1581-B	96073	4	1
21-038	82807	13	18	27G2241-2	96073	3	1
21-039	82807	13	24	29G1960-2	96073	2	15
21-040	82807	13	20	29G1986-1	96073	7	11
21-064	82807	13	23	29G1986-2	96073	8	17
21-213L	82807	13	22	29G1986-3	96073	8	12
21-213R	82807	13	12	29G1986-4	96073	8	10
21-905	82807	13	3	29G1986-5	96073	8	16
21-908-003	82807	13	39	29G1986-6	96073	7	31
21-908-004	82807	13	41				

Section IV. INDEX— FEDERAL STOCK NUMBER AND REFERENCE NUMBER

CROSS-REFERENCE TO FIGURE AND ITEM NUMBER (Cont)

<u>Reference No.</u>	<u>Mfg Code</u>	<u>Fig. No.</u>	<u>Item No.</u>	<u>Reference No.</u>	<u>Mfg Code</u>	<u>Fig. No.</u>	<u>Item No.</u>
29G1986-7	96073	7	24	6N8F50602	81133	7	20
29G1986-8	96073	2	12	634-2516-80-00241	30323	1	10
29G2037	96073	10	1	637-003-685	75138	7	42
29G2060	96073	14	5	7R2036	96073	8	7
29G2061	96073	14	9	71-1L	02660	12	5
29R691-50	96073	14	6	78-1L	02660	10	10
3G1817	96073	1	2	78S8	02660	9	12
3G1823	96073	9	4	78S8	02660	11	18
3G1831	96073	12	10	8G1286	96073	7	26
3G2175A	96073	1	6	8G149	96073	7	3
3G2175B	96073	1	12	8G2137F	96073	3	21
3G2250	96073	1	8	8G2156	96073	7	9
3G2286	96073	1	13	8G2197	96073	3	11
30393-9	09023	5	9	8G2198	96073	4	5
30993	00779	9	38	8G2205	96073	5	2
30993	00779	10	7	8G2233-5	96073	4	7
30997	00779	10	6	8G2255	96073	4	4
31-053-005	82807	13	29	8G2264E	96073	3	12
31G1943	96073	3	4	8G2264S	96073	3	13
31G1944	96073	3	8	8G2280	96073	11	6
31G1944-1	96073	3	6	8G2286	96013	5	7
31G1946	96073	3	7	8G2287	96073	7	8
31G1946-1	96073	3	5	8G2288	96073	3	15
31256	00779	2	14	8G2303	96073	3	3
31256	00779	6	18	8G2305	96073	9	29
31256	00779	7	19	8G2308	96073	9	48
31256	00779	10	11	8G2311	96073	9	50
314020	75915	7	34	8R2301	96073	7	51
32G1780-FED	96073	9	2	8R2306	96073	9	24
3200X4	79470	12	2	80300BJ	04009	10	12
3326X4	79470	14	2	82605	04009	11	20
4G1216	96073	6	11	8262C22	04845	12	7
4G1228	96073	8	18	86CP8	02660	9	10
4700-12W	44655	11	27	864	83330	6	13
5HKS10	56289	6	14	9G1646-3	96073	9	8
5100-202-323	72765	9	18	913	75543	12	9
5104	44655	8	4	969-001-759	75138	9	42
5150	44655	9	11	9700L276-216	73803	10	9

By Order of the Secretary of the Army:

Official:

VERNE L. BOWERS,
Major General, United States Army
The Adjutant General.

W. C. WESTMORELAND,
General, United States Army
Chief of Staff.

Distribution:

To be distributed in accordance with DA Form 12-25, Section I (qty rqr block no. 183)
Direct and General Support Maintenance requirements for Welding Equipment.

RECOMMENDED CHANGES TO EQUIPMENT TECHNICAL PUBLICATIONS



THEN...JOT DOWN THE
DOPE ABOUT IT ON THIS FORM.
CAREFULLY TEAR IT OUT, FOLD IT
AND DROP IT IN THE MAIL.

SOMETHING WRONG WITH PUBLICATION

FROM: (PRINT YOUR UNIT'S COMPLETE ADDRESS)

DATE SENT

PUBLICATION NUMBER

PUBLICATION DATE

PUBLICATION TITLE

BE EXACT PIN-POINT WHERE IT IS

PAGE
NO.

PARA-
GRAPH

FIGURE
NO.

TABLE
NO.

IN THIS SPACE, TELL WHAT IS WRONG
AND WHAT SHOULD BE DONE ABOUT IT.

TEAR ALONG PERFORATED LINE

PRINTED NAME, GRADE OR TITLE AND TELEPHONE NUMBER

SIGN HERE

The Metric System and Equivalents

Linear Measure

1 centimeter = 10 millimeters = .39 inch
 1 decimeter = 10 centimeters = 3.94 inches
 1 meter = 10 decimeters = 39.37 inches
 1 dekameter = 10 meters = 32.8 feet
 1 hectometer = 10 dekameters = 328.08 feet
 1 kilometer = 10 hectometers = 3,280.8 feet

Weights

1 centigram = 10 milligrams = .15 grain
 1 decigram = 10 centigrams = 1.54 grains
 1 gram = 10 decigrams = .035 ounce
 1 dekagram = 10 grams = .35 ounce
 1 hectogram = 10 dekagrams = 3.52 ounces
 1 kilogram = 10 hectograms = 2.2 pounds
 1 quintal = 100 kilograms = 220.46 pounds
 1 metric ton = 10 quintals = 1.1 short tons

Liquid Measure

1 centiliter = 10 milliliters = .34 fl. ounce
 1 deciliter = 10 centiliters = 3.38 fl. ounces
 1 liter = 10 deciliters = 33.81 fl. ounces
 1 dekaliter = 10 liters = 2.64 gallons
 1 hectoliter = 10 dekaliters = 26.42 gallons
 1 kiloliter = 10 hectoliters = 264.18 gallons

Square Measure

1 sq. centimeter = 100 sq. millimeters = .155 sq. inch
 1 sq. decimeter = 100 sq. centimeters = 15.5 sq. inches
 1 sq. meter (centare) = 100 sq. decimeters = 10.76 sq. feet
 1 sq. dekameter (are) = 100 sq. meters = 1,076.4 sq. feet
 1 sq. hectometer (hectare) = 100 sq. dekameters = 2.47 acres
 1 sq. kilometer = 100 sq. hectometers = .386 sq. mile

Cubic Measure

1 cu. centimeter = 1000 cu. millimeters = .06 cu. inch
 1 cu. decimeter = 1000 cu. centimeters = 61.02 cu. inches
 1 cu. meter = 1000 cu. decimeters = 35.31 cu. feet

Approximate Conversion Factors

To change	To	Multiply by	To change	To	Multiply by
inches	centimeters	2.540	ounce-inches	newton-meters	.007062
feet	meters	.305	centimeters	inches	.394
yards	meters	.914	meters	feet	3.280
miles	kilometers	1.609	meters	yards	1.094
square inches	square centimeters	6.451	kilometers	miles	.621
square feet	square meters	.093	square centimeters	square inches	.155
square yards	square meters	.836	square meters	square feet	10.764
square miles	square kilometers	2.590	square meters	square yards	1.196
acres	square hectometers	.405	square kilometers	square miles	.386
cubic feet	cubic meters	.028	square hectometers	acres	2.471
cubic yards	cubic meters	.765	cubic meters	cubic feet	35.315
fluid ounces	milliliters	29.573	cubic meters	cubic yards	1.308
pints	liters	.473	milliliters	fluid ounces	.034
quarts	liters	.946	liters	pints	2.113
gallons	liters	3.785	liters	quarts	1.057
ounces	grams	28.349	liters	gallons	.264
pounds	kilograms	.454	grams	ounces	.035
short tons	metric tons	.907	kilograms	pounds	2.205
pound-feet	newton-meters	1.356	metric tons	short tons	1.102
pound-inches	newton-meters	.11296			

Temperature (Exact)

°F Fahrenheit temperature 5/9 (after subtracting 32) Celsius temperature °C

PIN: 005434-000